

STATE OF MICHIGAN  
DEPARTMENT OF NATURAL RESOURCES  
TIMBER SALE MAP

SALE NO. YEAR SALE TYPE

32-022-05-01

STATE FOREST AND FOREST AREA GWINN MANAGEMENT UNIT	MAPPED BY J. KOSKI	DATE 9/20/2004
T 45N R 26W Section(s) 16	Sub. SESW, S <sup>1</sup> / <sub>2</sub> SE, NWSE	Scale: 1 Inch = <sup>1</sup> / <sub>4</sub> mile

COVER TYPE

DENSITY

- |                 |                    |                    |                  |                           |                       |
|-----------------|--------------------|--------------------|------------------|---------------------------|-----------------------|
| A - Aspen       | H - Hemlock        | P - Lowland Poplar | V - Bog or Marsh | 1 - Non Stocked           | 7 - Saw Timber Poor   |
| B - Paper Birch | J - Jack Pine      | Q - Mx Swamp Cnpr  | W - White Pine   | 2 - Seedling Sapling Poor | 8 - Saw Timber Medium |
| C - Cedar       | L - Lowland Brush  | R - Red Pine       | X - Non Stocked  | 3 - Seedling Sapling Well | 9 - Saw Timber Well   |
| E - Swamp Hdwds | M - Mpl. Bch. Brch | S - Black Spruce   | Z - Water        | 4 - Pole Timber Poor      |                       |
| F - Spruce Fir  | N - Marsh          | T - Tamarack       |                  | 5 - Pole Timber Medium    |                       |
| G - Grass       | O - Oak            | U - Upland Brush   |                  | 6 - Pole Timber Well      |                       |

Crooked Lake Road Pine

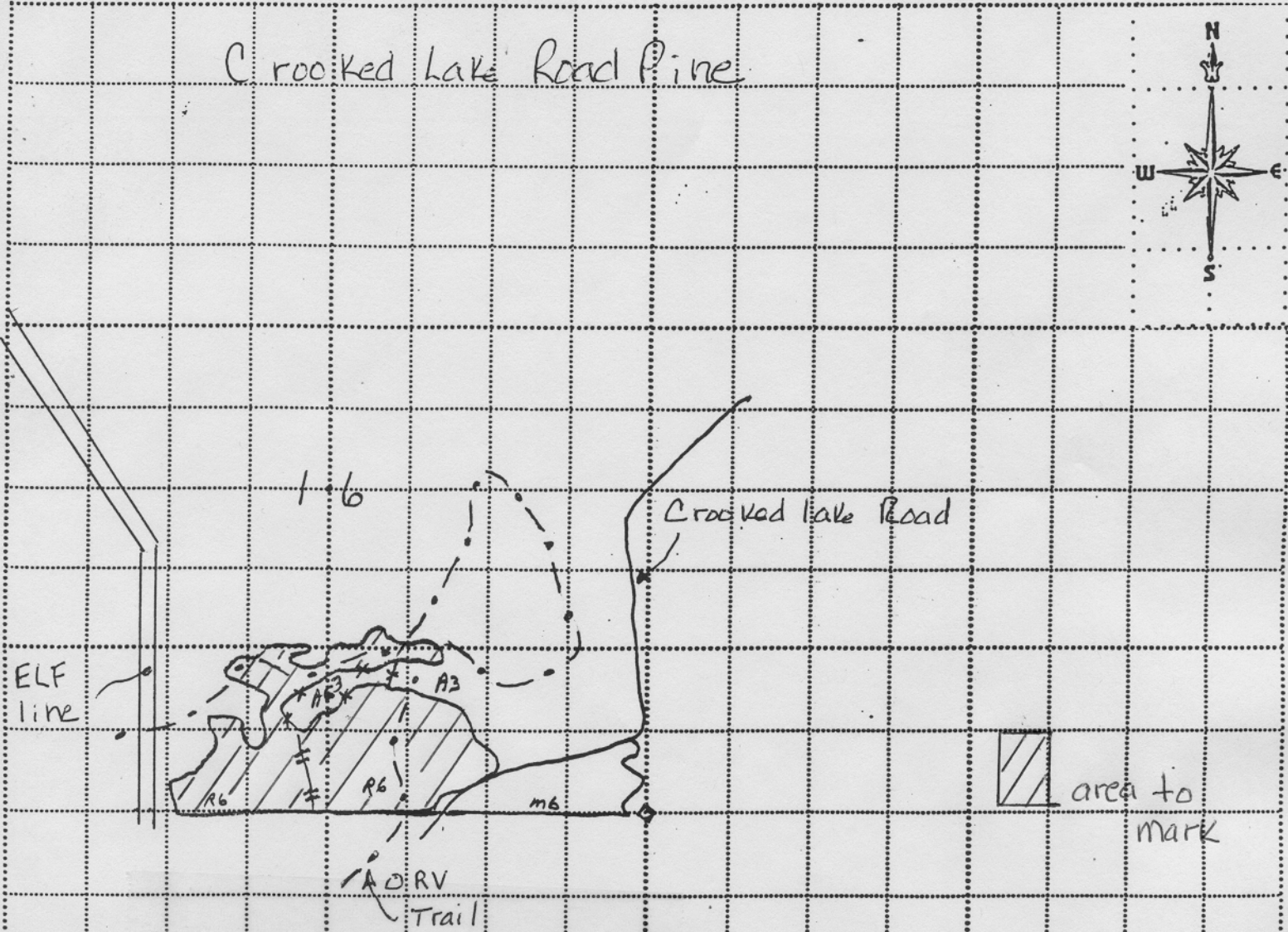
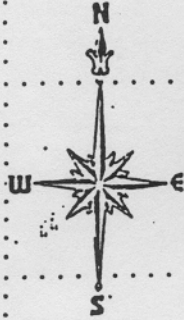

- oo Red Paint
- \*\* Red unit lines
- ##
- 1, 2, 3 Payment Units