

# "C18 Pipeline Popple"

## 241 Acres

COMPARTMENT 18  
 T17N, R6W, SEC. 3, 10, 11  
 T18N, R6W, SEC. 27, 34, 35  
 COUNTY: CLARE  
 UNIT: GLADWIN  
 FOREST: AU SABLE  
 YOE: 2005  
 ACRES: 2,610 GIS CALCULATED  
 MAP REVISED: 810512003  
 STAND EXAMINER:

Fence Line  
 used for  
 Blue Private  
 Line

~ Red painted Line  
 + Yellow Painted Line  
 ● Blue Painted Line

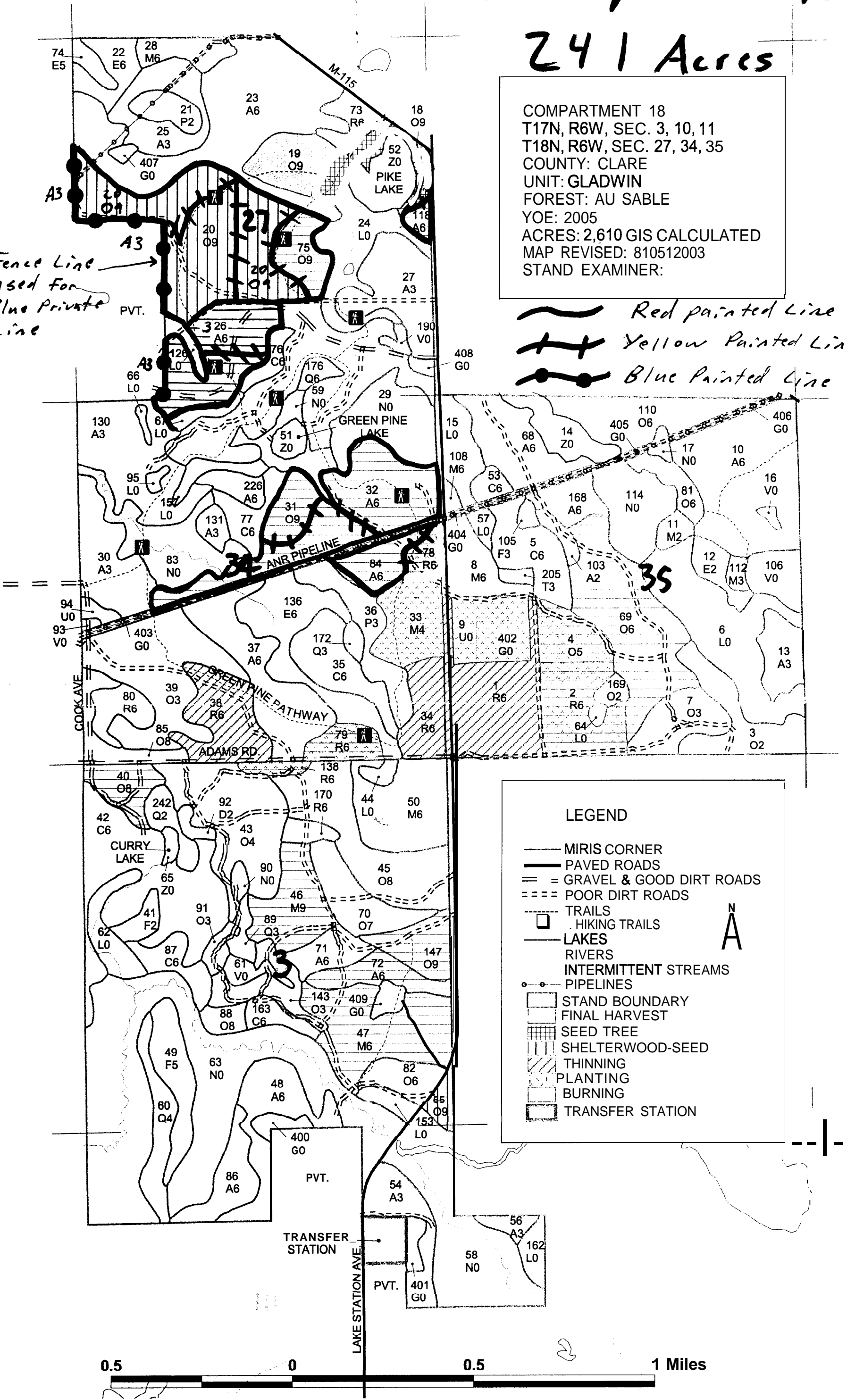

**LEGEND**

- MIRIS CORNER
- PAVED ROADS
- == GRAVEL & GOOD DIRT ROADS
- POOR DIRT ROADS
- - - TRAILS
- HIKING TRAILS
- LAKES
- RIVERS
- - - INTERMITTENT STREAMS
- PIPELINES
- STAND BOUNDARY
- FINAL HARVEST
- SEED TREE
- SHELTERWOOD-SEED
- THINNING
- PLANTING
- BURNING
- TRANSFER STATION

0.5 0 0.5 1 Miles