



TIMBER SALE MAP

This information provided under authority of Part 525, Act 451 of 1994, as amended.

Unit No.	Sale No.	Year	Sale Type
32	105	05	01

Forest Management Unit Guinn		Mapped by: Tom Seabloom		Cruised by:		Date 5-23-05	
Township 48N	Range 30W	Section(s) 2		Subdivision NW		Scale 1 inch = $\frac{1}{4}$ mile	

COVER TYPE

- | | | | | |
|---------------------|----------------|-------------------------|----------------------|------------------|
| A = Aspen | F = Spruce Fir | L = Lowland Brush | Q = Mixed Swamp Cnfr | V = Bog or Marsh |
| B = Paper Birch | G = Grass | M = Maple, Beech, Birch | R = Red Pine | W = White Pine |
| C = Cedar | H = Hemlock | N = Marsh | S = Black Spruce | X = Non Stocked |
| D = Treed Bog | J = Jack Pine | O = Oak | T = Tamarack | Y = Sand Dunes |
| E = Swamp Hardwoods | K = Rock | P = Lowland Poplar | U = Upland Brush | Z = Water |

DENSITY

- | | |
|---------------------------|-----------------------|
| 1 = Non Stocked | 6 = Pole Timber Well |
| 2 = Seedling Sapling Poor | 7 = Saw Timber Poor |
| 3 = Seedling Sapling Well | 8 = Saw Timber Medium |
| 4 = Pole Timber Poor | 9 = Saw Timber Well |
| 5 = Pole Timber Medium | |

South Boars Nest
59 Acres

Payment Units
1 - 30 Acres
2 - 29 Acres

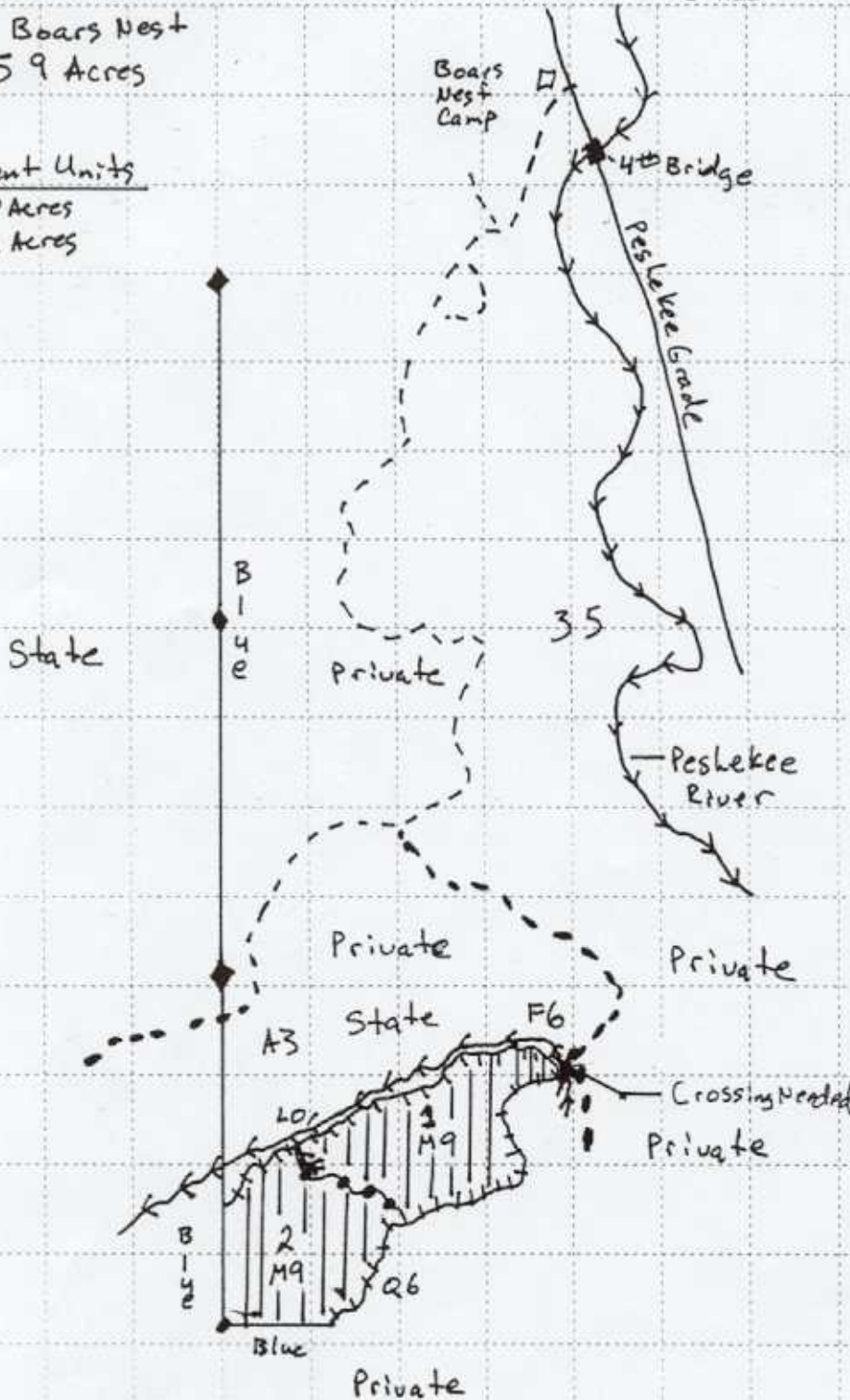

- Legend**
- Red Sale Boundary
 - Yellow Payment Unit
 - Good Dirt Road
 - Poor/Winter Road
 - Water Course
 - Survey Corner (Head)
 - GPS Corner (Head)