



Michigan Department of Natural Resources – Forest, Mineral and Fire Management

TIMBER SALE MAP

This information provided under authority of Part 525, Act 451 of 1994, as amended.

Unit No.	Sale No.	Year	Sale Type
32	101	06	01

Forest Management Unit Gwinn		Mapped by: D. Wilson	Cruised by: D. Wilson	Date 4/18/05
Township T49N	Range R26W	Section(s) 3	Subdivision E1/2SW	Scale: 1 inch = 1/4 mile

COVER TYPE

- | | | | | |
|---------------------|----------------|-------------------------|----------------------|------------------|
| A = Aspen | F = Spruce Fir | L = Lowland Brush | Q = Mixed Swamp Cnfr | V = Bog or Marsh |
| B = Paper Birch | G = Grass | M = Maple, Beech, Birch | R = Red Pine | W = White Pine |
| C = Cedar | H = Hemlock | N = Marsh | S = Black Spruce | X = Non Stocked |
| D = Tread Bog | J = Jack Pine | O = Oak | T = Tamarack | Y = Sand Dunes |
| E = Swamp Hardwoods | K = Rock | P = Lowland Poplar | U = Upland Brush | Z = Water |

DENSITY

- | | |
|---------------------------|-----------------------|
| 1 = Non Stocked | 6 = Pole Timber Well |
| 2 = Seedling Sapling Poor | 7 = Saw Timber Poor |
| 3 = Seedling Sapling Well | 8 = Saw Timber Medium |
| 4 = Pole Timber Poor | 9 = Saw Timber Well |
| 5 = Pole Timber Medium | |

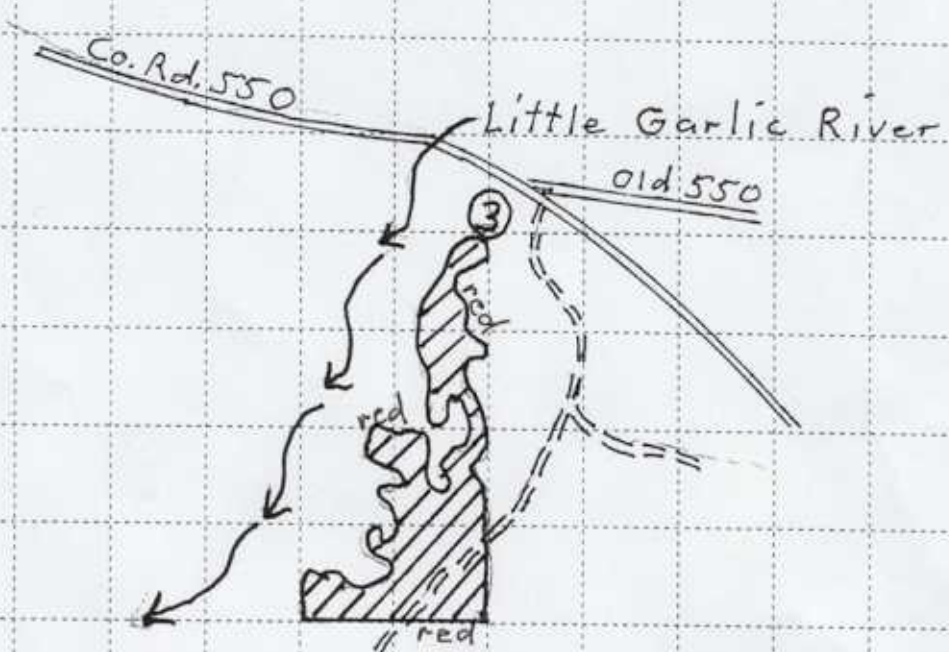

 Area to be marked.