



**SHINGLETON FOREST MANAGEMENT UNIT  
COMPARTMENT REVIEW PRESENTATION**

**COMPARTMENT #82 ENTRY YEAR: 2011**

**Compartment Acreage: 1680 County: Schoolcraft**

---

**Revision Date: 10/20/09**

**Stand Examiner: Bob Burnham**

**Legal Description: T41N R17W Sections 2,11,14,15**

**RMU (if applicable):**

**Management Goals:** The goals in this compartment include conducting multiple resource management for current and future generations. Forest Health, Recreation, Biodiversity Stewardship, Wildlife and Timber Management are some of the key management components within this compartment.

**Soil and Topography:** The soils in the compartment are mainly a mix of sands ranging from loamy to fine. The topography overall is relatively flat to slightly rolling.

**Ownership Patterns, Development, and Land Use in and Around the Compartment:** Ownership within the compartment is fairly contiguous, immediately west of the compartment boundary there are numerous private homes and 1 mile to the east is the west shore of Indian Lake. There is a State owned gravel pit within Section 15 as well as a County Pit adjacent. In addition, there are several other gravel pits to the northwest. This area receives a high amount of illegal dumping. The Enbridge Gas Pipeline crosses section 15.

**Unique, Natural Features (include only non-site specific and non-sensitive information):** Currently under review by Michigan Natural Features Inventory (MNFI).

**Archeological, Historical, and Cultural Features (include only non-site specific and non-sensitive information):** None known.

**Special Management Designations or Considerations:** Most of section 2 lies within the Big Spring Deeryard and the southern end of section 14 is within an openland complex managed for openland species such as sharp-tailed grouse.

**Watershed and Fisheries Considerations:** Silver Creek and Dufour Creek are found in this compartment and support trout. . BMP's should be implemented to control sediment sources from adjacent uplands. Fine sediments such as silt and sand negatively affect natural reproduction of fish, decrease the diversity of aquatic invertebrate and fish taxa, and result in lower overall fish populations.

**Wildlife Habitat Considerations:** This compartment lies just north of the Thompson Plains west of Indian Lake, and is divided by M-148. Aspen is a dominant species in stands here. Past management practices have created diversity in age classes across the landscape; this management scheme will continue, providing multiple age classes for a variety of wildlife species. Some northern hardwoods stands are also present. White pine as well as red and jack pines are components within many of the stands. This compartment

presents one of the better opportunities for game management in the Shingleton Forest Area. The wildlife goals include maintaining diversity in age and distribution of the aspen stands, maintaining birch, oak, hemlock, and cedar where present, maintaining and encouraging species and structural diversity in northern hardwoods, and providing super-canopy white pine.

**Mineral Resource and Development Concerns and/or Restrictions:** Surface sediments consist of an end moraine of medium-textured till and lacustrine (lake) sand & gravel. The glacial drift thickness varies between 10 and 100 feet. The Silurian Manistique and Burnt Bluff Groups subcrop below the glacial drift. The Burnt Bluff is quarried for stone in the area and the Manistique could be used for stone. The Roberts pit is located in Section 15 and there is potential. There is no commercial oil and gas production in the UP.

**Vehicle Access:** M-149 a State Highway runs through the compartment and there are many other two-tracks which provide excellent access to the compartment.

**Survey Needs:** None at the present time.

**Recreational Facilities and Opportunities:** There is a snowmobile trail that runs through sections 2, 11 and 15. In addition, the West Shore Campground of Indian Lake State Park sits 1 mile to the east and Palm's Book State Park is a few miles to the north. There are a growing number of equestrian users within the area as well.

**Fire Protection:** The compartment has very good access and is located fairly close to the Thompson Fire Garage. The openlands to the south are generally managed through prescribed burning activities.

**Additional Compartment Information:**

- **The following 5 reports from the Operations Inventory System (OIPC) are attached:**
  - ◆ **Cover Type by Age Class**
  - ◆ **Cover Type by Management Objective**
  - ◆ **Compartment Volume Summary**
  - ◆ **Proposed Treatments – No Limiting Factors**
  - ◆ **Proposed Treatments – With Limiting Factors**
  
- **The following information is displayed, where pertinent, on the attached compartment maps:**
  - ◆ **Base feature information, stand numbers, cover types**
  - ◆ **Proposed treatments**
  - ◆ **Proposed road access system**
  - ◆ **Suggested potential old growth**

11/2/2009 11:40:25 AM

Michigan Department of Natural Resources - Operations Inventory System  
Individual Compartment Report

LAKE SUPERIOR STATE FOREST

SHINGLETON FOREST MGT UNIT

SCHOOLCRAFT COUNTY

COMPARTMENT: 82

Table 3

(acres shown in boxes)

STAND AGE CLASS

COVER TYPE	Not Coded	0-9	10-19	20-29	30-39	40-49	50-59	60-69	70-79	80-89	90-99	100-109	110-119	120-129	130-139	140-149	150-159	All Aged	Total
Aspen		87	59	386	398	29	51		116										1126
Grass	66																		66
Hemlock										10				10					20
Jack Pine		114																	114
Lowlnd Brush	18																		18
Mx Swmp Cnfr										9									9
Non Stocked	6																		6
Red Pine						9			47	1									57
Rock	15																		15
Upland Hdwds				4	9				110	11		3						71	208
White Pine									31	10									41
<b>Total</b>	<b>105</b>	<b>201</b>	<b>59</b>	<b>390</b>	<b>407</b>	<b>38</b>	<b>51</b>		<b>304</b>	<b>41</b>		<b>3</b>		<b>10</b>				<b>71</b>	<b>1680</b>

11/2/2009 11:40:27 AM

Michigan Department of Natural Resources - Operations Inventory System  
Individual Compartment Report

LAKE SUPERIOR STATE FOREST

SHINGLETON FOREST MGT UNIT

SCHOOLCRAFT COUNTY

COMPARTMENT: **82**

Table 3A

(acres shown in boxes)

MANAGEMENT OBJECTIVE TYPE

COVER TYPE	A	S	V	C	G	H	J	I	L	P	N	Q	X	O	B	R	K	Y	F	E	T	D	U	M	Z	W	Total
A Aspen	1126																										1126
G Grass					66																						66
H Hemlock						20																					20
J Jack Pine							114																				114
L Lowlnd Brush									18																		18
Q Mx Swmp Cnfr												9															9
X Non Stocked													6														6
R Red Pine															57												57
K Rock																15											15
M Upland Hdwds																								208			208
W White Pine																										41	41
<b>Total</b>	1126				66	20	114		18			9	6		57	15								208		41	1680

LAKE SUPERIOR STATE FOREST

SHINGLETON FOREST MGT UNIT

SCHOOLCRAFT COUNTY

COMPARTMENT: **82**

**Table 10 - COMPARTMENT VOLUME SUMMARY - ALL STANDS**

COMPARTMENT SUMMARY			
TOTAL VOLUME		CUT VOLUME	
Hardwood	12765 Cds	Hardwood	4409 Cds
Hardwood	576 Mbf	Hardwood	167 Mbf
Softwood	2665 Cds	Softwood	529 Cds
Softwood	988 Mbf	Softwood	366 Mbf
Sum TotVol	18558 Cds	Sum CutVol	6004 Cds
<b>Total Cmpt Acres</b>		Acres Proposed For Cut.....	375
1680			

## SHINGLETON FOREST MGT UNIT

Proposed Treatments  
With NO Limiting Factors

Compartment: 82

Entry Year: 2011

Stand	Cover Type	Acres	Age	Site Index	Mgt Obj	Condition	Method Cut	Harvest Priority	Cultural Need	FDF Status
10	M9	40		62	northern hardwood	unevenaged	selection	2		
comnts Fmd : Nice hardwood stand, protect drainage within stand on east side and vernal pond on north end, stand 61 will be retention for this stand. No winter logging due to the snowmobile trail.										
Wld : Leave some large wolfy trees and a yellow birch component where present in the stand.										
13	R9	25	69	66	red pine	immature	thinning	2		prescribed for fdf treatment
comnts Fmd : Stand first thinned in 1983 Rainbow Block Stand second thinned in 1994 Headwater Red Pine Stand third thinned in the spring of 2003 Silver Creek Memorial No winter logging due to the snowmobile trail.										
16	R9	5	69	66	red pine	immature	thinning	2		prescribed for fdf treatment
comnts Fmd : Include C-81 stand 37 same prescription. Stand first thinned in 1983 Rainbow Block Stand second thinned in 1994 Headwater Red Pine Stand third thinned in the spring of 2003 Silver Creek Memorial No winter logging due to the snowmobile trail.										
17	R9	17	74	65	red pine	immature	thinning	1		
comnts Fmd : Stand has been thinned twice, last in 1993 BG Sale; Could be thinned once more prior to liquidation but much of the stand is the right size for Utility Poles. Due to the large clearcut along M-149 to the south hold stand 1 more decade prior to final harvest, thin now. Make certain the producer gets an M-Dot permit to work in the R-O-W.										
21	A6	22	72	53	aspen (upland)	mature	final harvest	2		
comnts Fmd : Aspen, fir and birch are mature, leave retention along drainages within stand, stand will regenerate to some portion of the current species mix.										
Wld : In addition to FMFM comments, leave any cedar and hemlock present.										
22	R6	9	43	56	red pine	immature	thinning	2		
comnts Fmd : Will be the first thinning. Make certain the producer gets an M-Dot permit to work in the R-O-W.										
26	J3	114	1	55	jack pine	immature		0	other - specify in remarks	
comnts Fmd : [6-2-04 BB] Part of Danko Sale 41-030-01-01, Units 3&4, Sale is now closed, waiting for scarification. (5/28/08 AP) Trenched and planted in spring 2008. Needs regen check in 2009. (6/15/09 AP) 3 year regen check needed in 2011. 2009 check - 1079 jack pine										
29	A6	56	69	56	aspen (upland)	mature	final harvest	1		
comnts Fmd : Stand is over-mature, jack pine has all but fallen out of stand; cut stand and manage for aspen, leave some red and white pine for seed and diversity also any oak if present.										
30	M6	25	74	57	northern hardwood	immature	selection	2		
comnts Fmd : Nice stand of hardwood with excellent hard maple potential. Quite a bit of aspen not showing on plots. Treat stand and release poles. Stand will need survey work. There are many mounds within stand which were actually caused by excavating for gravel many years ago (30+).										
31	W6	8	72	53	white pine	immature	shelterwood-seed	2		
comnts Fmd : Stand is pine aspen on edge of hardwood. Stand needs to be cut, manage by doing a shelterwood seed cut which will perpetuate the stand as pine/aspen. However, aspen may take over as the predominate species which is ok. Will need survey work.										
42	W6	5	72	58	white pine	immature	shelterwood-seed	2		
comnts Fmd : Aspen is over-mature, do a shelterwood seed cut and manage for a mixed stand.										
43	M6	14	72	57	northern hardwood	two aged	selection	2		
comnts Fmd : Do a selection cut to make some holes within stand to add structure. Cut most of the red pine logs. Unit manager wants half of the red pine logs retained.										
45	M6	2	69	58	northern hardwood	immature	selection	2		
comnts Fmd : Small even aged pole stand, do a selection cut to make some canopy gaps to move the stand toward all-aged. No winter logging due to the snowmobile trail.										

## SHINGLETON FOREST MGT UNIT

Proposed Treatments  
With NO Limiting Factors

Compartment: 82

Entry Year: 2011

Stand	Cover Type	Acres	Age	Site Index	Mgt Obj	Condition	Method Cut	Harvest Priority	Cultural Need	FDF Status
<b>46</b>	<b>M6</b>	9	69	58	northern hardwood	immature	selection	2		
comnts Fmd : Small even aged pole stand, do a selection cut to make some canopy gaps to move the stand toward all-aged. No winter logging due to the snowmobile trail.										
Wld : Leave hemlock and other conifers in the stand to promote stand diversity. Buffer any vernal pools.										
<b>47</b>	<b>M6</b>	3	69	58	northern hardwood	immature	selection	2		
comnts Fmd : Small even aged pole stand, do a selection cut to make some canopy gaps to move the stand toward all-aged. No winter logging due to the snowmobile trail.										
<b>48</b>	<b>M6</b>	1	69	58	northern hardwood	immature	selection	2		
comnts Fmd : Small even aged pole stand, do a selection cut to make some canopy gaps to move the stand toward all-aged. No winter logging due to the snowmobile trail.										
<b>56</b>	<b>M6</b>	16	69	57	northern hardwood	immature	selection	2		
comnts Fmd : Pole stand of varying quality, protect drainage that runs through stand. Stand is even aged, do a selection cut to make canopy gaps to move stand toward all aged system. No winter logging due to the snowmobile trail.										
Wld : Leave any hemlock, and some large wolfy trees a yellow birch component where present in the stand.										
<b>67</b>	<b>W6</b>	10	78	52	white pine	mature	seed tree	2		
comnts Fmd : Stand was once a jack pine stand but it is over-mature and the jack pine has fallen out, the aspen is also over-mature. The white pine within stand is 2 aged. Do a seedtree cut allowing the aspen to regenerate and manage for a mixed stand. Leave legacy white pine as well as smaller diameter white pine.										
<b>70</b>	<b>A6</b>	15	72	58	aspen (upland)	mature	final harvest	2		
comnts Fmd : Southern end has some cabbage white pine, exclude this area for retention. Western line may be off due to old adjacent sale. Leave some white pine throughout stand as well and manage for a mixed stand as it currently is.										
Wld : In addition to FMFM comments, leave some cherry and any oak.										
<b>71</b>	<b>W6</b>	18	70	59	white pine	two aged	shelterwood-seed	2		
comnts Fmd : Stand is a 2 aged pine stand, the aspen and maple within stand are mature. Manage stand as a mixed pine aspen stand by doing a shelterwood seed cut to which will perpetuate the pine and allow aspen to regenerate.										
<b>72</b>	<b>A5</b>	51	54	52	aspen (upland)	mature	final harvest	2		
comnts Fmd : Stand was partially cut by aspen peelers in 1965 creating a 2 aged stand almost. The younger aged stuff could hold but the older stuff won't. Some jack pine within stand.										
<b>73</b>	<b>A6</b>	15	69	62	aspen (upland)	mature	final harvest	2		
comnts Fmd : South end is extremely nice aspen. Do not cut Oak, it occurs in the middle and to the north.										
Wld : In addition to FMFM comments, leave oak.										
<b>74</b>	<b>A6</b>	8	69	62	aspen (upland)	mature	final harvest	2		
comnts Fmd : Do not cut Oak.										
<b>75</b>	<b>R9</b>	1	79	62	red pine	mature	seed tree	1		
comnts Fmd : Small stand of mature red pine clearcut and replant, leave a few mature pine. Due the size of the stand it was decided at pre-review to change cut type to seedtree and cut in the summer to get the soil scuffed.										
<b>Total Acres.....</b>		<b>489</b>								

**Proposed Treatments  
With Limiting Factors**

**Compartment: 82**

**Entry Year: 2011**

---

<b>Stand</b>	<b>Cover Type</b>	<b>Acres</b>	<b>Age</b>	<b>Site Index</b>	<b>Mgt Obj</b>	<b>Condition</b>	<b>Method Cut</b>	<b>Harvest Priority</b>	<b>Cultural Need</b>	<b>FD Status</b>
--------------	-----------------------	--------------	------------	-----------------------	--------------------	------------------	-----------------------	-----------------------------	--------------------------	----------------------

---

TREATMENT LIMITING FACTORS:

---

**Total Acres..... 0**

# Covertypes & Treatment Map

Compartment 82  
 T41N, R17W, Sec. 2, 11, 14, 15  
 County: Schoolcraft  
 Unit: Shingleton  
 YOE: 2011  
 Acres: 1,680 GIS Calculated  
 Stand Examiner: Robert Burnham  
 Map Revised: 10/29/2009  
 Map Phase: Pre-Review

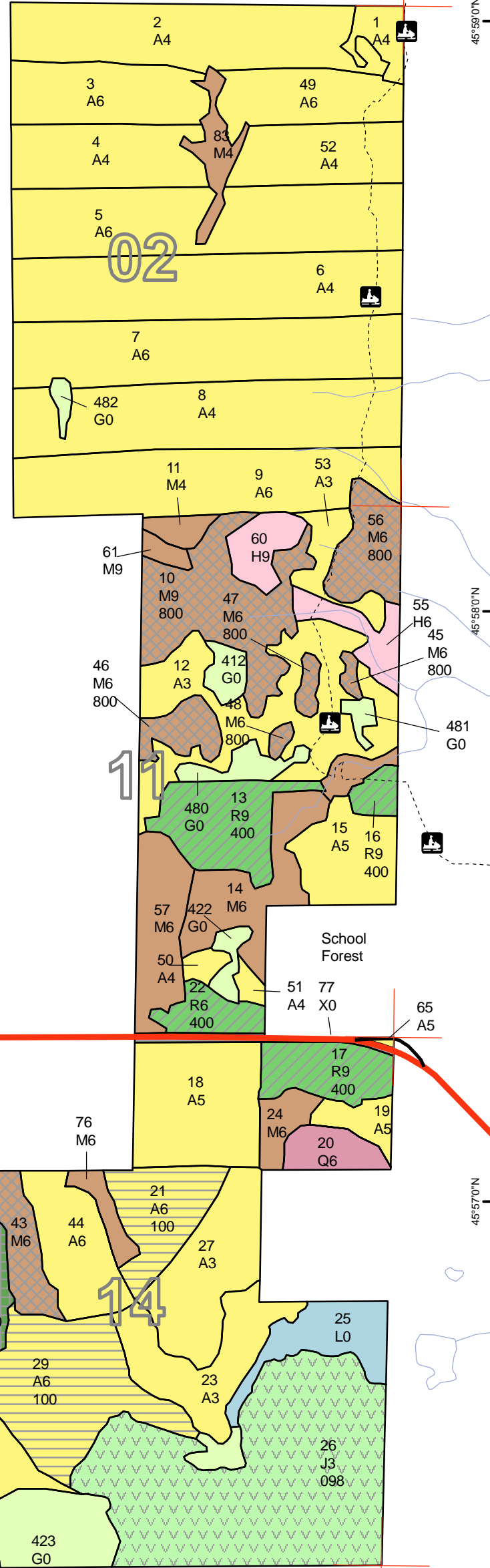
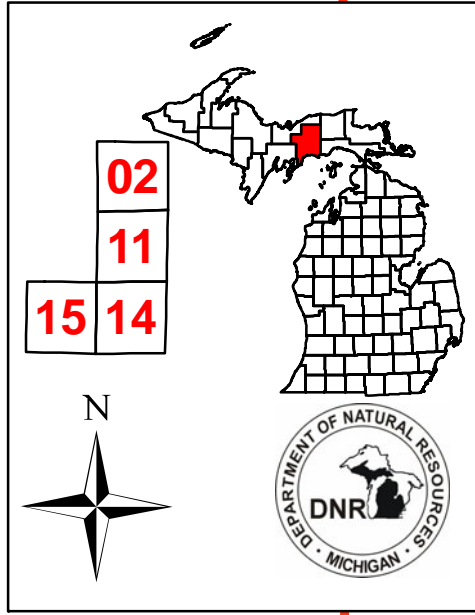

**Legend**

— Miris Corners	<b>Treatments</b>
— Highway	098 - Other
— County Paved Roads	100 - Final harvest
— Paved Roads	200 - Seed Tree
— Gravel Roads	300 - Shelterwood-seed
— Poor Dirt Roads	400 - Thinning
— Trails	800 - Selection
— Water Features	A - Aspen
— Snowmobile Trails	G - Grass
— Stand Boundaries	H - Hemlock
	J - Jack Pine
	K - Rock
	L - Lowland Brush
	M - Northern Hardwoods
	Q - Mixed Swamp Conifers
	R - Red Pine
	W - White Pine
	X - Non-Stocked

Co. Rd. 442

15

11

14

1 Miles

1 0.5 0

# Stand Boundary Map

Compartment 82  
 T41N, R17W, Sec. 2, 11, 14, 15  
 County: Schoolcraft  
 Unit: Shingleton  
 YOE: 2011  
 Acres: 1,680 GIS Calculated  
 Stand Examiner: Robert Burnham  
 Map Revised: 10/29/2009  
 Map Phase: Pre-Review

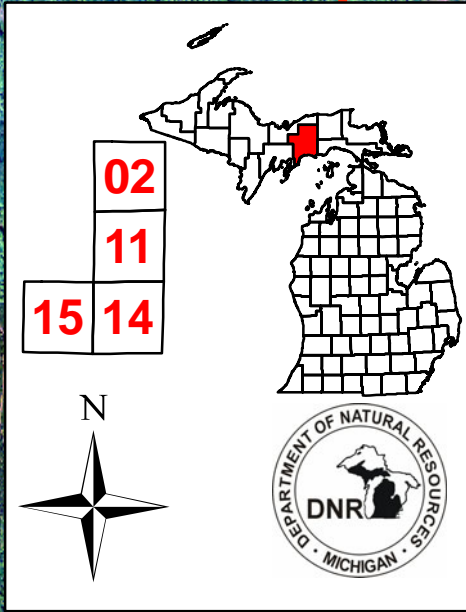

## Legend

- Miris Corners
- Highway
- County Paved Roads
- Paved Roads
- = = Gravel Roads
- - Poor Dirt Roads
- ..... Trails
- Water Features
- Snowmobile Trails
- Stand Boundaries

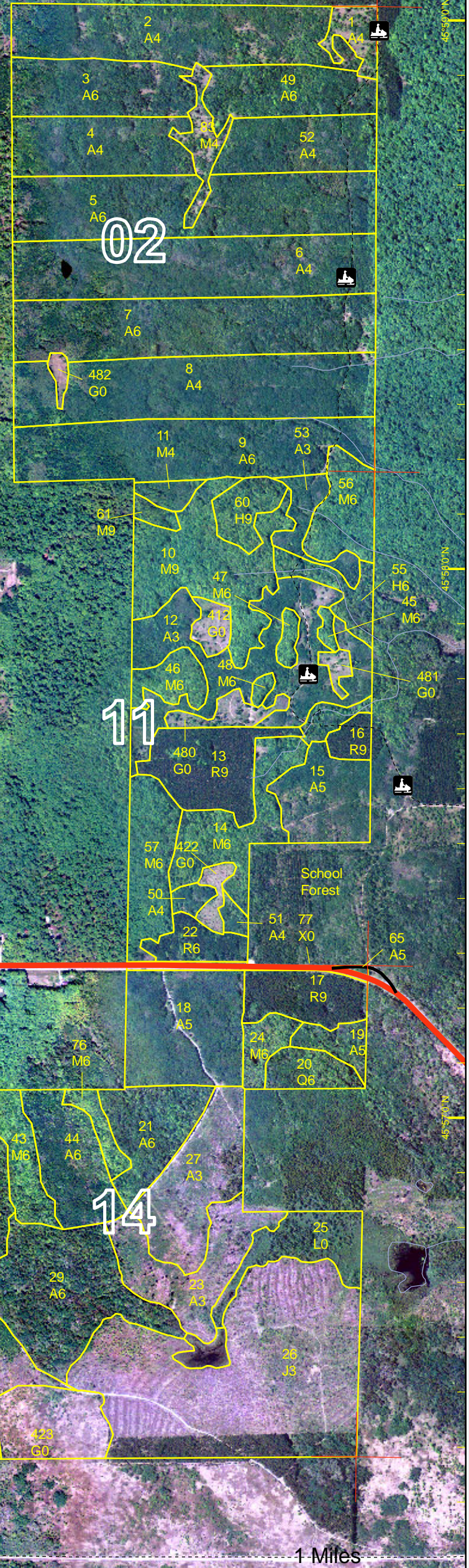

# Dedicated & Proposed Special Conservation Area Map

Compartment 82  
 T41N, R17W, Sec. 2, 11, 14, 15  
 County: Schoolcraft  
 Unit: Shingleton  
 YOE: 2011  
 Acres: 1,680 GIS Calculated  
 Stand Examiner: Robert Burnham  
 Map Revised: 10/29/2009  
 Map Phase: Pre-Review

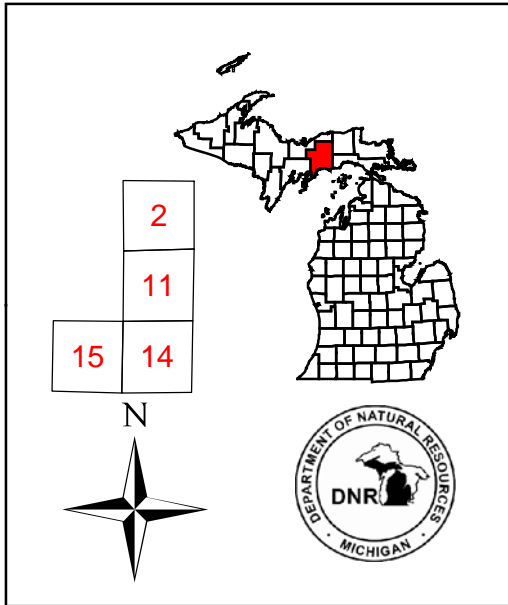

**Legend**

- Miris Corners
- Stand Boundaries
- Dedicated Special Conservation Areas
- Deer Wintering Areas

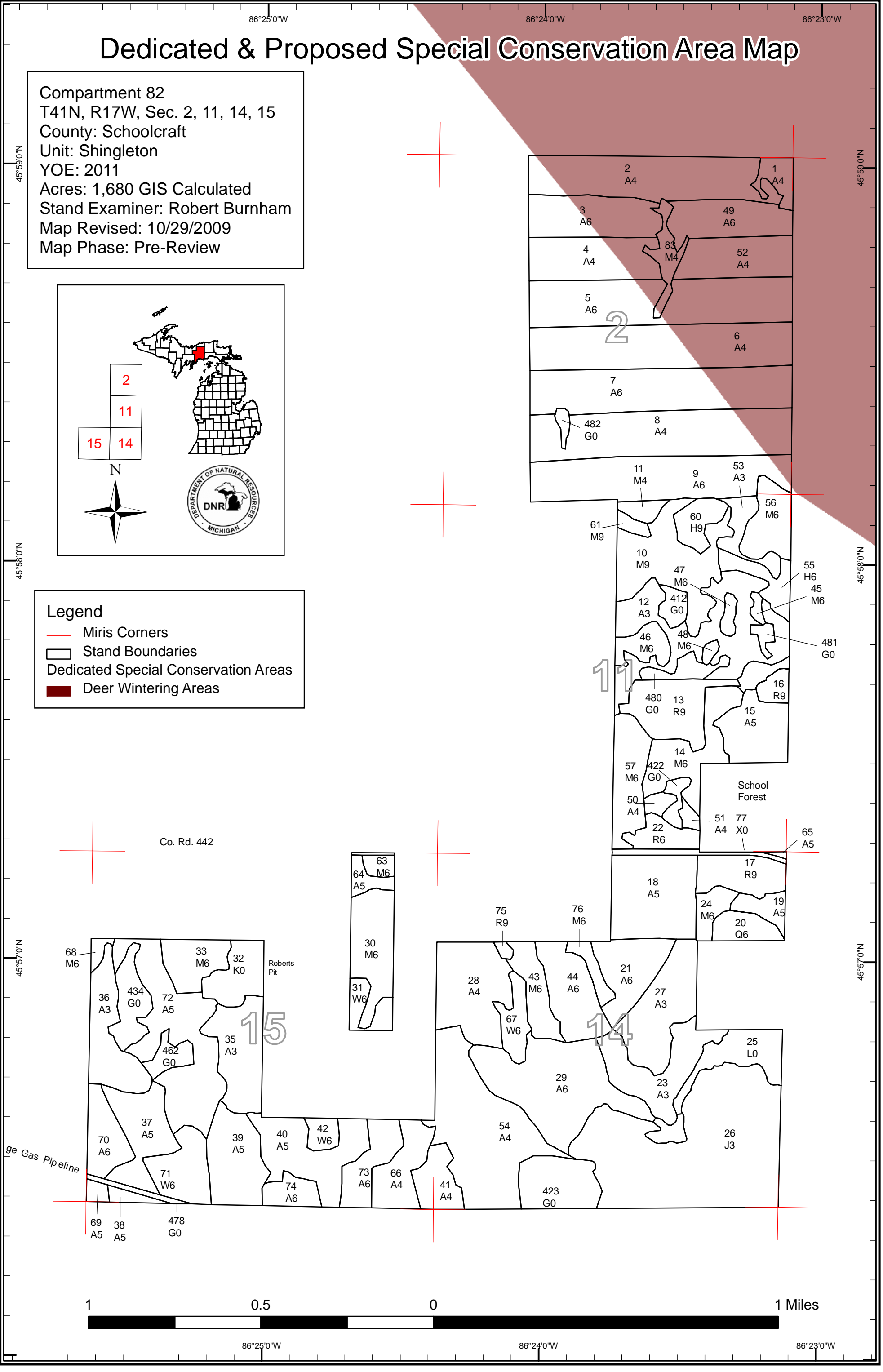
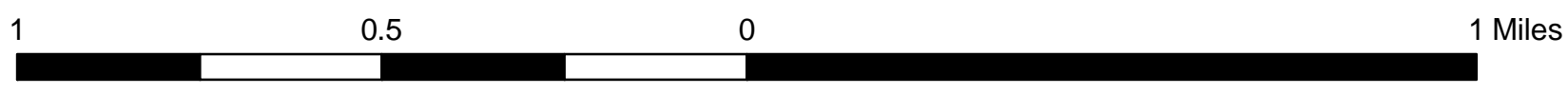
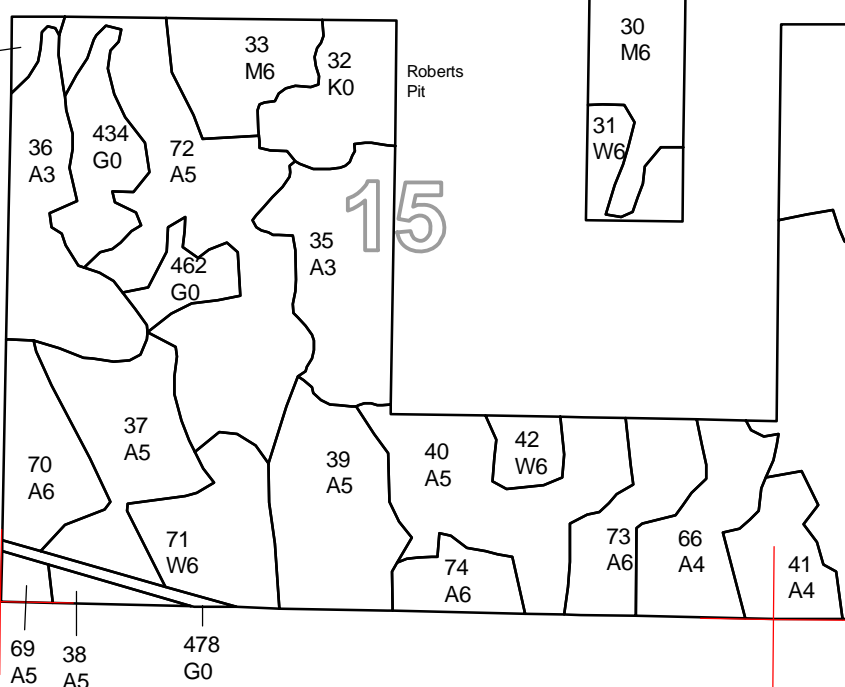
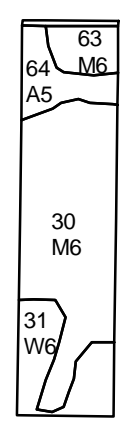
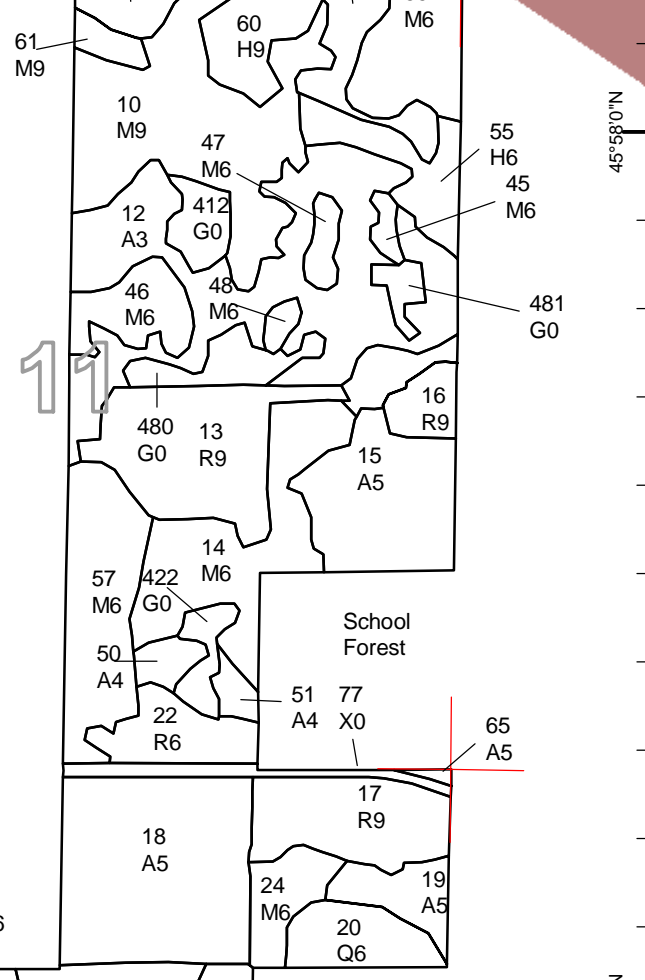
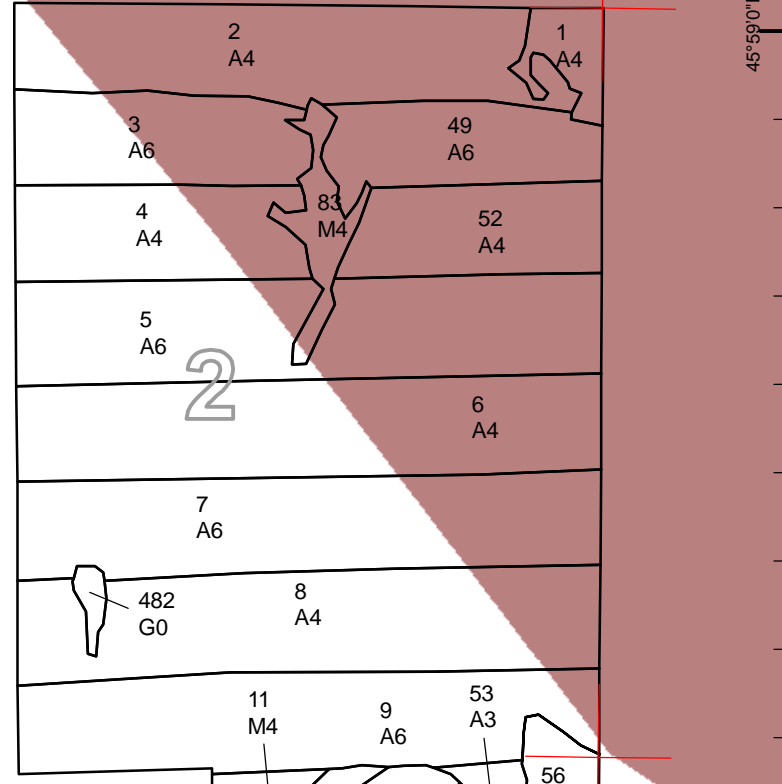



## DEDICATED CONSERVATION AREA DETAILS

\* This is a list of Dedicated Biodiversity Areas for this compartment along with a 1/4 mile buffer surrounding the compartment. Refer to Dedicated Conservation Area Map for areas that the below listed Conservation Areas are located.

ERA = Ecological Reference Area  
 HCVA = High Conservation Value Area  
 SCA = Special Conservation Area

Conservation Area	Type	Description
SCA	Cold Water Stream	A coldwater stream has temperature and dissolved oxygen conditions that allow naturally-reproduced or stocked trout populations and those of other coldwater fish species (e.g., slimy sculpin) to persist from year to year. Coldwater streams in Michigan typically provide these conditions due to substantial contributions of groundwater to their stream flows. Such streams are established by Director's action and designated as trout resources by Fisheries Order 210.
SCA	Habitat Area	An area that provide some specific need for the life cycle of wildlife species, including State Wildlife Areas and Waterfowl Production Areas, deer wintering complexes in lowland conifer communities, grassland openings and savannas. Habitat areas are distinct from critical habitat designated for recovery of endangered or threatened species (such as Kirtland's warbler or piping plover areas) in that they are more general in nature, are not primarily associated with threatened or endangered species, and are not covered by species recovery plans that are developed in cooperation with Federal agencies.