



**SHINGLETON FOREST MANAGEMENT UNIT
COMPARTMENT REVIEW PRESENTATION**

COMPARTMENT # 85 ENTRY YEAR: 2008

Compartment Acreage: 1927 County: Schoolcraft

Revision Date: 10/11/2006

Stand Examiner: Tom Burnis

Legal Description: T41N R17W Sections 22,27,34

RMU (if applicable):

Management Goals: The main goal of this compartment is to conduct multiple resource management for current and future generations.

Soil and Topography: The topography is mostly level with dry sandy soils.

Ownership Patterns, Development, and Land Use in and Around the Compartment: This entire compartment is state owned and mostly surrounded by state land. There are two pipe lines, two power lines, a railroad, state highway and a county road running across this compartment. Recreational hunting is wide spread throughout the area.

Unique, Natural Features (include only non-site specific and non-sensitive information): Currently under review by Michigan Natural Features Inventory.

Archeological, Historical, and Cultural Features (include only non-site specific and non-sensitive information): None known.

Special Management Designations or Considerations: Large areas of grass lands are maintained as wildlife openings.

Watershed and Fisheries Considerations: There are no fisheries concerns.

Wildlife Habitat Considerations: This compartment lies within the area known as the Thompson Plains. Early records show the pre-settlement forest was a composite of northern hardwood stand interspersed with an open pine plains complex. The hardwood stands contained species such as hemlock, sugar maple, birch, and beech. The open plains were dominated by red and white pine, but also contained jack pine and oak. Surveyors also noted Indian hunting trails that crossed this area. In it's current condition, the compartment continues to contain large openings, however much of the former hardwood stands have been converted to oak and aspen. The wildlife habitat goals for this compartment include maintaining the large open complexes, promoting oak regeneration, and enhancing the age and structural composition of the aspen community. Variable retention guidelines will be utilized.

Mineral Resource and Development Concerns and/or Restrictions: Surface sediments consist of lacustrine (lake) sand and gravel. The glacial drift thickness varies between 10 and 50 feet. The Silurian

Manistique Group subcrops below the glacial drift. The Manistique could be used for stone. A gravel pit is located in Section 26 and potential appears to be good. A dimension stone quarry is located two miles to the northwest. There is no commercial oil and gas production in the UP.

Vehicle Access: The entire compartment is highly accessible to vehicles as there are many two track roads of good quality throughout the area.

Survey Needs: None

Recreational Facilities and Opportunities: The only recreational facility in the compartment is a snowmobile trail which links Cooks and Manistique. Opportunities include hunting.

Fire Protection: Access to this area is very easy for fire equipment.

Additional Compartment Information:

- **The following 5 reports from the Operations Inventory System (OIPC) are attached:**
 - ◆ **Cover Type by Age Class**
 - ◆ **Cover Type by Management Objective**
 - ◆ **Compartment Volume Summary**
 - ◆ **Proposed Treatments – No Limiting Factors**
 - ◆ **Proposed Treatments – With Limiting Factors**

- **The following information is displayed, where pertinent, on the attached compartment maps:**
 - ◆ **Base feature information, stand numbers, cover types**
 - ◆ **Proposed treatments**
 - ◆ **Proposed road access system**
 - ◆ **Suggested potential old growth**

11/02/2006 9:39:22 AM

Michigan Department of Natural Resources - Operations Inventory System
Individual Compartment Report

LAKE SUPERIOR STATE FOREST

SHINGLETON FOREST AREA

SCHOOLCRAFT COUNTY

COMPARTMENT: 85

Table 3

(acres shown in boxes)

STAND AGE CLASS

COVER TYPE	Not	STAND AGE CLASS																Total	
	Coded	0-9	10-19	20-29	30-39	40-49	50-59	60-69	70-79	80-89	90-99	100-109	110-119	120-129	130-139	140-149	150-159		All Aged
Aspen		131	309	109	102	80			27	15									773
Bog or Marsh	4																		4
Grass	278																		278
Jack Pine		7	7	71			19												104
Local Name	23																		23
Mx Swmp Cnfr								6											6
Oak									220										220
Red Pine			301				207												508
Upland Hdwds																		11	11
Total	305	138	617	180	102	80	226	6	247	15								11	1927

11/02/2006 9:39:26 AM

Michigan Department of Natural Resources - Operations Inventory System
Individual Compartment Report

LAKE SUPERIOR STATE FOREST

SHINGLETON FOREST AREA

SCHOOLCRAFT COUNTY

COMPARTMENT: 85

Table 3A

(acres shown in boxes)

MANAGEMENT OBJECTIVE TYPE

COVER TYPE	A	S	V	C	G	H	J	I	L	P	N	Q	X	O	B	R	K	Y	F	E	T	D	U	M	Z	W	Total
A Aspen	773																										773
V Bog or Marsh			4																								4
G Grass					278																						278
J Jack Pine							104																				104
I Local Name								23																			23
Q Mx Swmp Cnfr												6															6
O Oak														220													220
R Red Pine															508												508
M Upland Hdwds																								11			11
Total	773		4		278		104	23				6		220		508								11			1927

LAKE SUPERIOR STATE FOREST

SHINGLETON FOREST AREA

SCHOOLCRAFT COUNTY

COMPARTMENT: **85**

Table 10 - COMPARTMENT VOLUME SUMMARY - ALL STANDS

COMPARTMENT SUMMARY			
TOTAL VOLUME		CUT VOLUME	
Hardwood	10035 Cds	Hardwood	4013 Cds
Hardwood	240 Mbf	Hardwood	73 Mbf
Softwood	8205 Cds	Softwood	2018 Cds
Softwood	262 Mbf	Sum CutVol	6177 Cds
Sum TotVol	19244 Cds		
Total Cmpt Acres		Acres Proposed For Cut.....	493
1927			

SHINGLETON FOREST AREA

Proposed Treatments
With NO Limiting Factors

Compartment: 85

Entry Year: 2008

Stand	Cover Type	Acres	Age	Site Index	Mgt Obj	Condition	Method Cut	Harvest Priority	Cultural Need	FDF Status
4	A6	27	73	60	aspen (upland)	mature	final harvest	1	natural regeneration	
comnts Fmd : Mark oak to cut leaving 20 sqft. Residual to open crowns and promote aspen regen. Any of the current species mix will be acceptable regeneration.										
13	J2	7	5	52	jack pine	in process of regeneration		0	other - specify in remarks	
comnts Fmd : 3000 jack pine planted with inmates in spring of 2006. Regen check in 2007. History of this stand is recorded in comments of stand 16.										
16	J6	19	54	52	jack pine	immature	final harvest	1	natural regeneration	
comnts Fmd : PART OF STAND SALVAGED IN 1998. (stand 13) [7-15-01] Received a completion for 6 acres of machine (?) planting. [1/22/2004 BB] Regen was counted in the summer of 2003, TMS Kuhr reports the stand had heavy deer browse causing near complete mortality and recommends replanting with inmate labor. [1/22/04 BB] Received a completion from Dick indicating he planted 6 acres. Check regen in 2005 (8/24/05AP) 2005 Regen Check - 375 jack pine. Problems with deer browse in the past was not evident this time. Dry summer conditions caused excessive mortality in areas. On list to plant with inmates in spring 2006. (5/22/06AP) Stand planted with inmates in spring 2006 - 3000 jack pine. Regen check in 2007.										
20	O6	45	73	52	oak	immature	shelterwood-seed	2		
comnts Fmd : All species except oak cut out in 1992, mostly red maple regen, oak regen heavily browsed. Existing species mix is acceptable regeneration.										
21	O6	77	73	52	oak	immature	shelterwood-prep	1		
comnts Fmd : Open understory, no regen. Cut all species except oak and white pine. Thin oak to 50 sqft. Next entry.										
32	A6	15	78	60	aspen (upland)	mature	final harvest	1	natural regeneration	
comnts Fmd : Do not cut oak or white pine.										
55	Q6	6	64	51	mixed swamp conifer	immature	final harvest	1		
comnts Fmd : stand falling apart. Few nice red pine logs in NW tip. Cut all red pine, leave all white pine might get some white pine regen. Current species mix will be acceptable regen.										
66	O6	79	73	52	oak	immature	shelterwood-prep	1		
comnts Fmd : Cut all species except oak and white pine. Thin oak to 50sqft. Next entry.										
78	A5	18	31	60	aspen (upland)	immature	final harvest	1	natural regeneration	
comnts Fmd : Poor aspen and red maple. Cut to promote better stand and blend into stand 67. Existing species mix acceptable regen.										
347	R6	5	56	60	red pine	immature	thinning	2		stand with fdf potential
comnts Fmd : Thinned in 1991 and 2001. FDF										
348	R6	53	56	50	red pine	immature	thinning	2		stand with fdf potential
comnts Fmd : Thinned in 1991 and 2001. FDF										
350	R6	95	56	60	red pine	immature	thinning	2		stand with fdf potential
comnts Fmd : FDF, Thinned in 1991 and 2001. West 1/2 cut 2 and leave 4 rows previously, East 1/2 cut 1 leave 2.										
385	R3	74	8	58	red pine	immature		0	other - specify in remarks	stand with fdf potential
comnts Fmd : SALVAGE CUT 1998 FDF [3-14-02] Received regen survey results from Don showing 754 red pine trees/acre and 613 volunteers per acre. Release work still to come. FTP#41-893 [1/6/04 BB] Received completion for 52.5 total acres of release work for FTP which was completed in 8/03. Don indicates may still need more release work. (9/18/06AP) Portions of site were released in June 2006 with Velpar. FTP is being kept open to evaluate effectiveness of herbicide application.										
391	R6	54	56	60	red pine	immature	thinning	2		stand with fdf potential
comnts Fmd : FDF Second thinning complete spring 2001										

SHINGLETON FOREST AREA

**Proposed Treatments
With NO Limiting Factors**

Compartment: 85

Entry Year: 2008

Stand	Cover Type	Acres	Age	Site Index	Mgt Obj	Condition	Method Cut	Harvest Priority	Cultural Need	FDF Status
406	G0	91		59	grass	nonstocked		0	opening maintenance	
comnts Fmd : Cut in 1991 then maintained as grass. Filling in with aspen and jack pine.										
408	G0	77		60	grass	nonstocked		0	opening maintenance	
comnts Fmd : BURNED IN1997, filling in with aspen and cherry. Burn with grass stand in adjacent compartment.										
426	G0	59		60	grass	nonstocked		0	opening maintenance	
comnts Fmd : cancle FTP for burn and change to inmates with hand tools.										
468	G0	5		60	grass	nonstocked		0	opening maintenance	
comnts Fmd : cancle FTP for burn and change to inmates with hand tools.										

Total Acres..... 806

**Proposed Treatments
With Limiting Factors**

Compartment: 85

Entry Year: 2008

Stand	Cover Type	Acres	Age	Site Index	Mgt Obj	Condition	Method Cut	Harvest Priority	Cultural Need	FDF Status
--------------	-----------------------	--------------	------------	-----------------------	--------------------	------------------	-----------------------	-----------------------------	--------------------------	-----------------------

TREATMENT LIMITING FACTORS:

Total Acres..... 0

Field Map

Compartment 85
 T41N, R17W, Sec. 22, 27, 34
 County: Schoolcraft
 Unit: Shingleton
 YOY: 2008
 Acres: 1,927 GIS Calculated
 Stand Examiner: Tom Burnis
 Map Revised: 10/24/2006
 Map Phase: Pre-review

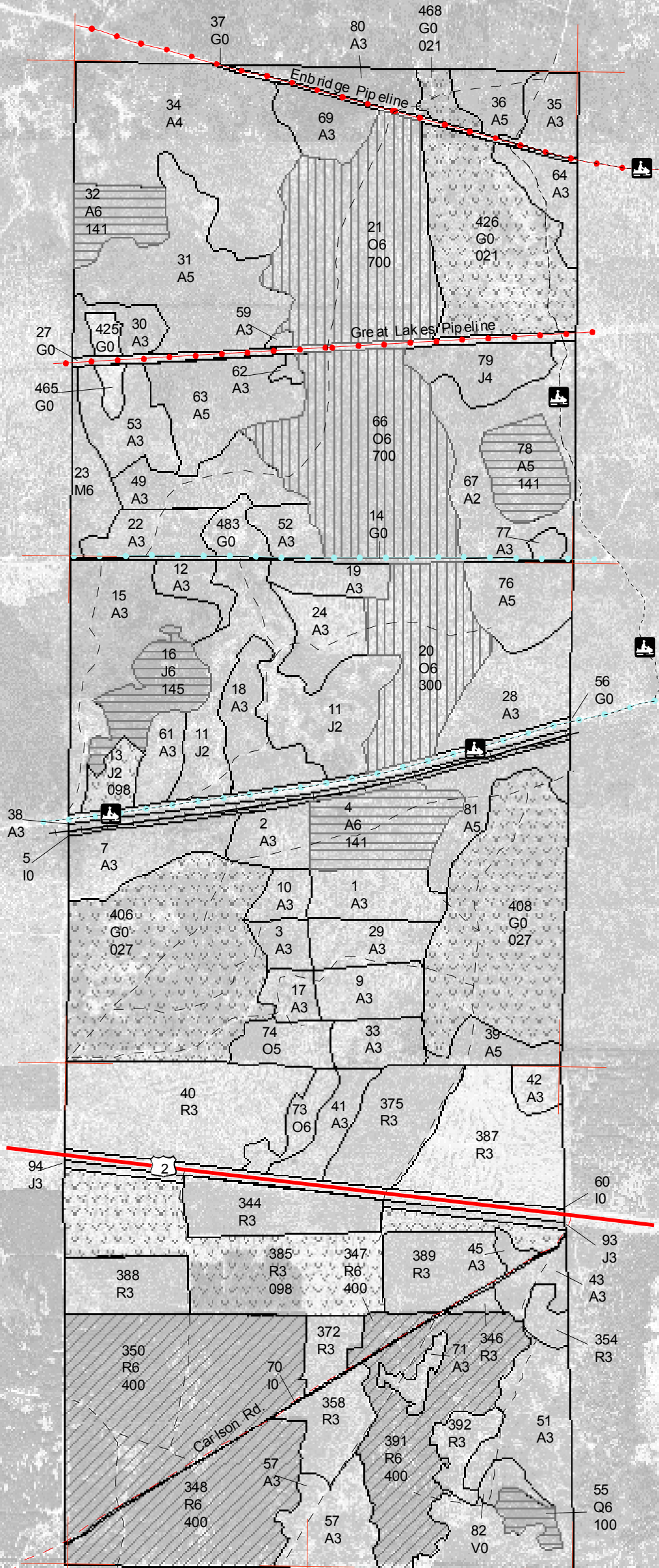
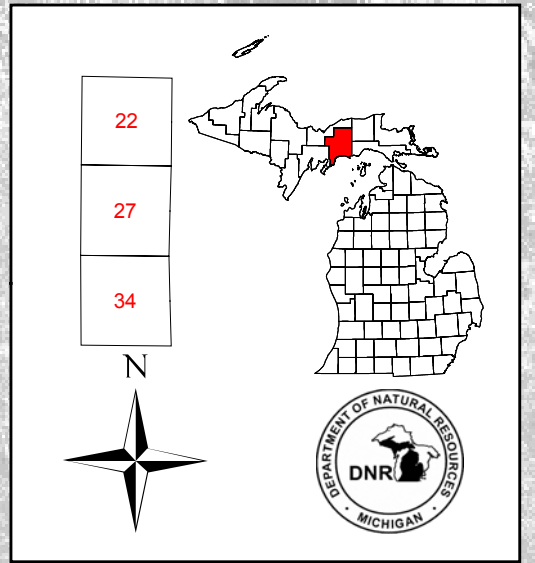

Legend

- Miris Corners
- Highways
- County Poor Dirt Roads
- Poor Dirt Roads
- Trails
- Pipelines
- Powerlines
- Railroads
- US Highway
- Snowmobile Trails
- 021 - Opening maintenance/Hand tools
- 027 - Opening maintenance/Prescribed burning
- 098 - Other/Other
- 100 - Final harvest
- 141 - Final harvest/Natural regeneration/Hand tools
- 145 - Final harvest/Natural regeneration/Mechanical
- 300 - Shelterwood-seed
- 400 - Thinning
- 700 - Shelterwood-prep
- Stand Boundaries

