



**SHINGLETON FOREST MANAGEMENT UNIT
COMPARTMENT REVIEW PRESENTATION**

COMPARTMENT # 171 ENTRY YEAR: 2007

Compartment Acreage: 1,205 County: Alger

Revision Date: 9/22/05

Stand Examiner: Jennifer Burnham

Legal Description: T47N R17W Sections 10 and 15

RMU (if applicable):

Management Goals: The main goal in this compartment is to conduct multiple resource management for current and future generations.

Soil and Topography: The topography in this compartment is hilly to flat with some low areas. The main soils in the compartment are; Ogemaw Sandy Loam with fair to good drainage and fair natural fertility, Munising Loam with good drainage and moderate natural fertility and Kalkaska Loamy Sand with good drainage and low to fair natural fertility. The entire compartment lies within the Munising Moraine Land Type Association.

Ownership Patterns, Development, and Land Use in and Around the Compartment: Ownership within the compartment is all State land except for the town of Melstrand on the south end. The surrounding land has broken ownership of State lands, CFR lands and private ownership. State land is heavily used by hunters while the roads are heavily used by those looking for fishing sites and access into PRNL properties to the northwest. The residents are a mix of year-round and seasonal.

Unique, Natural Features (include only non-site specific and non-sensitive information): Currently under review by Michigan Natural Features Inventory (MNFI).

Archeological, Historical, and Cultural Features (include only non-site specific and non-sensitive information): None known.

Special Management Designations or Considerations: Treatments that will be conducted around any water areas will follow all BMP regulations and those concerns addressed from other divisions.

Watershed and Fisheries Considerations: The upper reaches of Mosquito Creek are found in this compartment. Mosquito Creek is currently part of an experiment to re-introduce coaster brook trout on the south shore of Lake Superior. Thus, protection of this stream from sedimentation of spawning gravels is high priority. BMP's should be followed as inputs of sediment and increases in sand bedload need to be prevented.

Wildlife Habitat Considerations: This compartment is located immediately north, east, and west of Melstrand. The pre-settlement forest, as recorded by General Land Office surveyors appears to have been dominated by sugar maple, yellow birch, and beech. Hemlock and balsam fir were also common

components. Red maple, ironwood, and elm were recorded as minor components of the forest. Currently the northern hardwoods appear to have a stronger component of black cherry than during the pre-settlement days. Aspen is also a more significant part of the landscape than it was circa 1850. Wildlife habitat objectives include promoting diversity within the hardwoods, and maintaining the aspen component in the compartment.

Mineral Resource and Development Concerns and/or Restrictions: Surface sediments consist of end moraine of medium-textured glacial till. There is insufficient data to determine the glacial drift thickness. The Ordovician Prairie du Chien (PdC) Formation subcrops below the glacial drift. The PdC could be used for stone. The nearest gravel pit is in Section 15 or just to the east and there should be good potential. There is no commercial oil and gas production in the UP.

Vehicle Access: Access to the compartment is good with use of H-58 and County Road 639, Chapel Lake Road. There is also a good forest road system through out the compartment from past timber activities.

Survey Needs: None.

Recreational Facilities and Opportunities: This compartment is used regularly by hunters. There is also a good amount of traffic on the two main roads for those heading into the PRNL and those looking for fishing opportunities.

Fire Protection: Fire response to the area will be good. The Shingleton station is about 20 minutes from the compartment via H-15 and H-58. The current road system is good enough for fire operations; however the timber types present are not of high fire potential. Urban interface problems could occur with those homes or cabins around the compartment, however the majority of the timber is northern hardwoods.

Additional Compartment Information:

- **The following 5 reports from the Operations Inventory System (OIPC) are attached:**
 - ◆ **Cover Type by Age Class**
 - ◆ **Cover Type by Management Objective**
 - ◆ **Compartment Volume Summary**
 - ◆ **Proposed Treatments – No Limiting Factors**
 - ◆ **Proposed Treatments – With Limiting Factors**

- **The following information is displayed, where pertinent, on the attached compartment maps:**
 - ◆ **Base feature information, stand numbers, cover types**
 - ◆ **Proposed treatments**
 - ◆ **Proposed road access system**
 - ◆ **Suggested potential old growth**

10/05/2005 3:03:42 PM

Michigan Department of Natural Resources - Operations Inventory System
Individual Compartment Report

LAKE SUPERIOR STATE FOREST

SHINGLETON FOREST AREA

ALGER COUNTY

COMPARTMENT: 171

Table 3

(acres shown in boxes)

STAND AGE CLASS

COVER TYPE	Not Coded	0-9	10-19	20-29	30-39	40-49	50-59	60-69	70-79	80-89	90-99	100-109	110-119	120-129	130-139	140-149	150-159	All Aged	Total
Aspen			131	24	61				3									36	255
Cedar												15	91						106
Grass	15																		15
Marsh	13																		13
Non Stocked	9																		9
Red Pine				37															37
Rock	4																		4
Spruce Fir																		23	23
Swamp Hrdwds																		31	31
Treed Bog	22																		22
Upland Hdwds																		660	660
Water	15																		15
White Pine																		15	15
Total	78		131	61	61				3			15	91					765	1205

10/05/2005 3:03:48 PM

Michigan Department of Natural Resources - Operations Inventory System
Individual Compartment Report

LAKE SUPERIOR STATE FOREST

SHINGLETON FOREST AREA

ALGER COUNTY

COMPARTMENT: 171

Table 3A

(acres shown in boxes)

MANAGEMENT OBJECTIVE TYPE

COVER TYPE	A	S	V	C	G	H	J	I	L	P	N	Q	X	O	B	R	K	Y	F	E	T	D	U	M	Z	W	Total
A Aspen	247	8																									255
C Cedar				106																							106
G Grass					15																						15
N Marsh											13																13
X Non Stocked													9														9
R Red Pine																37											37
K Rock																	4										4
F Spruce Fir					14														9								23
E Swamp Hrdwds																				31							31
D Treed Bog																						22					22
M Upland Hdwds																								660			660
Z Water																									15		15
W White Pine																										15	15
Total	247	8		106	29						13		9		37	4		9	31		22		660	15	15	1205	

LAKE SUPERIOR STATE FOREST

SHINGLETON FOREST AREA

ALGER COUNTY

COMPARTMENT: **171**

Table 10 - COMPARTMENT VOLUME SUMMARY - ALL STANDS

TOTAL VOLUME		CUT VOLUME	
Hardwood	12722 Cds	Hardwood	584 Cds
Hardwood	363 Mbf	Hardwood	7 Mbf
Softwood	2120 Cds	Softwood	106 Cds
Softwood	123 Mbf	Sum CutVol	704 Cds
Sum TotVol	15814 Cds		
Total Cmpt Acres		Acres Proposed For Cut.....	78
1205			

SHINGLETON FOREST AREA

**Proposed Treatments
With NO Limiting Factors**

Compartment: 171 Entry Year: 2007

Stand	Cover Type	Acres	Age	Site Index	Mgt Obj	Condition	Method Cut	Harvest Priority	Cultural Need	FDF Status	
1	M6	23		58	northern hardwood	unevenaged	selection	2			
comnts Fmd : Stand needs to be treated with C172 stand 17. There is scattered cherry and beech in the stand with balsam fir about 3 feet tall. TSI might have been done in the '70's but no major cutting has taken place. Terrain is flat to rolling. MO is for northern hardwoods.											
2	F4	14		51	grass	immature	final harvest	1			
comnts Fmd : Old opening that is starting to fill in. There are some white spruce planted in rows (maybe 30 years ago), plus others seeding in on their own. Balsam fir is seeding in from surrounding stands.											
4	M6	4		50	northern hardwood	unevenaged	selection	2			
comnts Fmd : Needs to be treated with stand 1. Poor quality wood, flat terrain with some cherry and hemlock. MO is for northern hardwoods.											
10	M6	1		56	northern hardwood	unevenaged	selection	2			
comnts Fmd : Water surrounding part of the stand. Private to the west will allow access for harvesting. Most of the trees are poor quality. Cut to keep diversity. 99 in total volume = yellow birch and hemlock logs. 15 BA snags. MO is for northern hardwoods.											
21	M6	2		56	northern hardwood	unevenaged	selection	2			
comnts Fmd : Water surrounding part of the stand. Private to the west will allow access for harvesting. Most of the trees are poor quality. Cut to keep diversity. 99 in total volume = yellow birch and hemlock logs. 15 BA snags. MO is for northern hardwoods.											
25	M6	7		50	northern hardwood	unevenaged	selection	2			
comnts Fmd : Timber is not the best quality. Has paint on trees (faint) but never cut. Some white pine and fir coming up in the understory. MO is for northern hardwoods.											
31	M6	8		58	northern hardwood	unevenaged	selection	2			
comnts Fmd : Some white pine near the waters edge. Cut in '87 removing much of the overstory - understory is about 20-30' tall and doing well. Access will be best from the west through private land. South part of the stand changes slightly with poorer quality wood. MO is for northern hardwoods.											
42	A6	3	69	68	aspen (upland)	mature	final harvest	2	cleaning & weeding		
comnts Fmd : There is good hardwood reproduction in the understory, without treatment stand would convert easily. Some white pine, fir in understory. Scattered cherry and hilly terrain. MO of the stand is for aspen. Some conifers and hardwood will come back after the cut. This is okay.											
44	M6	5		60	northern hardwood	unevenaged	selection	2			
comnts Fmd : Pole stand that is fairly healthy. Understory has a good mix of species, better than over story. When treated go all the way to the Melstrand TT C180 stands 1, 2, 62. Old fire plow line on west side of stand. MO is for northern hardwoods.											
48	M6	10		50	northern hardwood	unevenaged	selection	2			
comnts Fmd : Mostly beech coming in for the understory. When treated mark to encourage species diversity. MO is for northern hardwoods.											
55	M6	1		58	northern hardwood	unevenaged	selection	2			
comnts Fmd : Older, poor quality trees. Thinning will help with hemlock and white pine reproduction. Stand needs to be treated with C172 stand 15. 30 BA snags. MO is for northern hardwoods.											
Total Acres.....		78									

**Proposed Treatments
With Limiting Factors**

Compartment: 171 **Entry Year: 2007**

Stand	Cover Type	Acres	Age	Site Index	Mgt Obj	Condition	Method Cut	Harvest Priority	Cultural Need	FDF Status
--------------	-----------------------	--------------	------------	-----------------------	--------------------	------------------	-----------------------	-----------------------------	--------------------------	-----------------------

TREATMENT LIMITING FACTORS:

Total Acres..... 0

Field Map

Compartment 171
 T47N, R17W, Sec. 10, 15
 County: Alger
 Unit: Shingleton
 YOE: 2007
 Acres: 1,205 GIS Calculated
 Stand Examiner: Jennifer Burnham
 Map Revised: 10/04/2005
 Map Phase: Pre-review

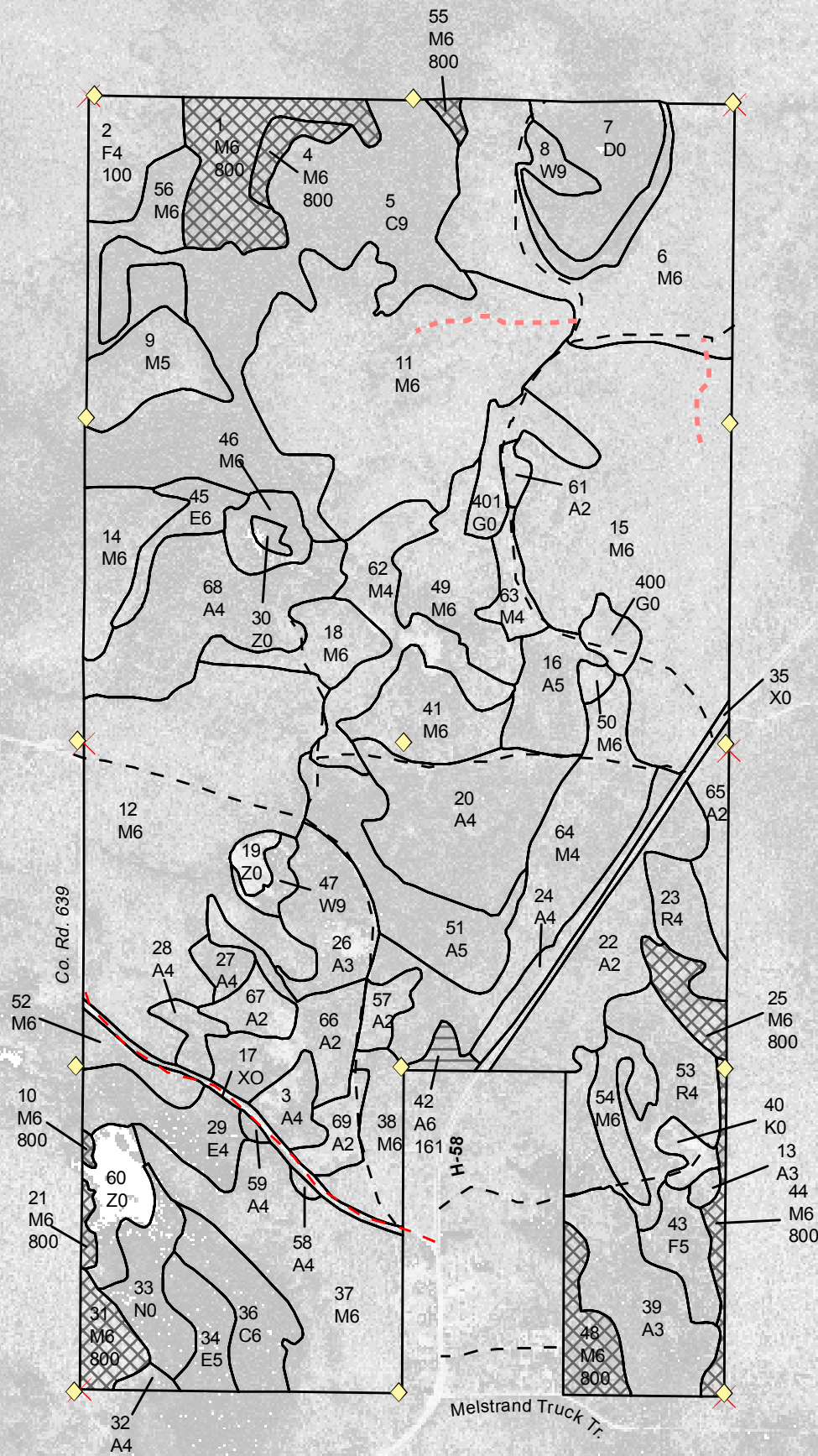
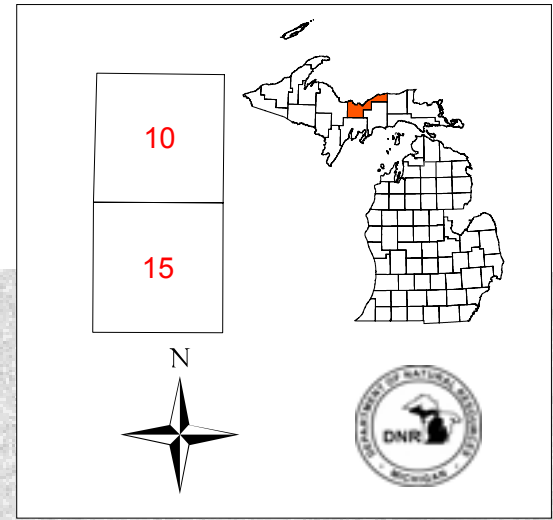

Legend

- ◆ RLS Corners
- ✕ GPS Corners
- - County Poor Dirt Roads
- - Poor Dirt Roads
- - Closed Roads
- ▭ Stand Boundary
- ▨ 161 - Final harvest/Cleaning-weeding/Hand tools
- ▩ 800 - Selection

Name County Paved Roads
Name County Gravel Roads
Name County Dirt Roads

