



**PIGEON RIVER COUNTRY MANAGEMENT UNIT  
COMPARTMENT REVIEW PRESENTATION**

**COMPARTMENT 4 ENTRY YEAR: 2009**

**Compartment Acreage: 1451      County: Cheboygan**

---

**Revision Date:**

August 23, 2007

**Stand Examiner:**

Rick McDonald

**Legal Description:**

T34N - R01W sections 22, 27, 34

**RMU (if applicable):**

Not Applicable

**Management Goals:**

Maintain current species mix and apply appropriate management techniques to mature stands of timber that are in need of treatment.

**Soil and Topography:**

Flat to gently rolling. Soils are mostly Rubicon and Cheboygan sands.

**Ownership Patterns, Development, and Land Use in and Around the Compartment:**

Entirely state owned.

**Unique, Natural Features (include only non-site specific and non-sensitive information):**

None identified.

**Archeological, Historical, and Cultural Features (include only non-site specific and non-sensitive information):**

None identified.

**Special Management Designations or Considerations:**

None identified.

**Watershed and Fisheries Considerations:**

Weed Creek starts in this compartment. It is part of the Black River watershed.

**Wildlife Habitat Considerations:**

Please refer to Wildlife Biologist's comments.

**Mineral Resource and Development Concerns and/or Restrictions:**

Sections 22, 27 and 34, T34N-R1W, Cheboygan County

Surface sediments consist of glacial outwash sand and gravel and postglacial alluvium and coarse-textured glacial till. The glacial drift thickness varies between 50 and 400 feet. Beneath the glacial drift are the Devonian Antrim Shale and Traverse Group that are quarried for cement products and limestone elsewhere in the State. Afton quarry is located four miles to the northwest. A gravel pit is located to the north and there is good potential on the uplands. This area was previously leased for oil and gas development. The Antrim Shale subcrops in this area and appears to be too thin for production. The Niagaran reef trend is located eleven miles to the southeast. There is limited oil and gas potential for known producing formations in this compartment.

Consistent with the objectives of the Concept of Management there are no plans to engage in mining activities (sand, gravel, stone, etc.) or oil and gas development in this Compartment. Nondevelopment (no surface infrastructure including pipelines, new roads, utility lines, well pads, etc.) oil and gas leasing may be considered.

**Vehicle Access:**

There is good access to most, if not all, of the compartment. Some of the roads, however, have been closed to wheeled motorized vehicles with berms or posts. Some closures are in need of repair.

**Survey Needs:**

None required.

**Recreational Facilities and Opportunities:**

No maintained recreational facilities exist within this compartment.

**Fire Protection:**

Access is generally good in case of any fire suppression efforts, though the area is generally at low risk to any wildfire potential. Some road systems are closed with berms or posts.

**Additional Compartment Information:**

- **The following 5 reports from the Operations Inventory System (OIPC) are attached:**
  - ◆ **Cover Type by Age Class**
  - ◆ **Cover Type by Management Objective**
  - ◆ **Compartment Volume Summary**
  - ◆ **Proposed Treatments – No Limiting Factors**
  - ◆ **Proposed Treatments – With Limiting Factors**
  
- **The following information is displayed, where pertinent, on the attached compartment maps:**
  - ◆ **Base feature information, stand numbers, cover types**
  - ◆ **Proposed treatments**
  - ◆ **Proposed road access system**
  - ◆ **Suggested potential old growth**

6/14/2007 10:33:48 AM

Michigan Department of Natural Resources - Operations Inventory System  
Individual Compartment Report

MACKINAW STATE FOREST

PIGEON RIVER COUNTRY MGT UNIT

CHEBOYGAN COUNTY

COMPARTMENT: 4

Table 3

(acres shown in boxes)

STAND AGE CLASS

COVER TYPE	Not Coded	0-9	10-19	20-29	30-39	40-49	50-59	60-69	70-79	80-89	90-99	100-109	110-119	120-129	130-139	140-149	150-159	All Aged	Total
Aspen			93	11		477												68	649
Black Spruce									4										4
Bog or Marsh	6																		6
Cedar									6			8		74					88
Grass	15																		15
Hemlock										14									14
Jack Pine						6													6
Lowlnd Brush	19																		19
Marsh	32																		32
Mx Swmp Cnfr												154		48					202
Red Pine					8	7		28	9	69		23						67	211
Swamp Hrdwds							25		8		37								70
Treed Bog	34																		34
Upland Brush	20																		20
Upland Hdwds				14		17												13	44
White Pine					15													22	37
<b>Total</b>	<b>126</b>		<b>93</b>	<b>25</b>	<b>23</b>	<b>507</b>	<b>25</b>	<b>28</b>	<b>27</b>	<b>83</b>	<b>37</b>	<b>185</b>		<b>122</b>				<b>170</b>	<b>1451</b>

6/14/2007 10:33:53 AM

Michigan Department of Natural Resources - Operations Inventory System  
Individual Compartment Report

MACKINAW STATE FOREST

PIGEON RIVER COUNTRY MGT UNIT

CHEBOYGAN COUNTY

COMPARTMENT: 4

Table 3A

(acres shown in boxes)

MANAGEMENT OBJECTIVE TYPE

COVER TYPE	A	S	V	C	G	H	J	I	L	P	N	Q	X	O	B	R	K	Y	F	E	T	D	U	M	Z	W	Total
A Aspen	649																										649
S Black Spruce		4																									4
V Bog or Marsh			6																								6
C Cedar				88																							88
G Grass					15																						15
H Hemlock						14																					14
J Jack Pine							6																				6
L LowInd Brush									19																		19
N Marsh											32																32
Q Mx Swmp Cnfr												202															202
R Red Pine															211												211
E Swamp Hrdwds																			70								70
D Treed Bog																						34					34
U Upland Brush																								20			20
M Upland Hdwds																								44			44
W White Pine																										37	37
<b>Total</b>	649	4	6	88	15	14	6		19		32	202			211				70			34	20	44		37	1451

MACKINAW STATE FOREST

PIGEON RIVER COUNTRY MGT UNIT

CHEBOYGAN COUNTY

COMPARTMENT: 4

**Table 10 - COMPARTMENT VOLUME SUMMARY - ALL STANDS**

COMPARTMENT SUMMARY			
TOTAL VOLUME		CUT VOLUME	
Hardwood	9388 Cds	Hardwood	1513 Cds
Hardwood	291 Mbf	Softwood	256 Cds
Softwood	7575 Cds	Softwood	532 Mbf
Softwood	1735 Mbf	Sum CutVol	2833 Cds
Sum TotVol	21015 Cds		
<b>Total Cmpt Acres</b>		Acres Proposed For Cut.....	161
1451			

**PIGEON RIVER COUNTRY MGT UNIT**

**Proposed Treatments  
With NO Limiting Factors**

**Compartment: 4**

**Entry Year: 2009**

Stand	Cover Type	Acres	Age	Site Index	Mgt Obj	Condition	Method Cut	Harvest Priority	Cultural Need	FDF Status	
6	A6	39	39	65	aspen (upland)	immature	final harvest	1			
comnts Fmd : Some scattered openings throughout the stand. Clearcut with reserves.											
11	A6	22	41	70	aspen (upland)	immature	final harvest	1			
comnts Fmd : Clearcut with reserves. Leave clumps of Fir to be cut later.											
14	A6	14	41	70	aspen (upland)	immature	final harvest	1			
comnts Fmd : Clearcut with reserves. Leave clumps of Fir to be cut later.											
25	R9	8	103	55	red pine	mature	shelterwood-seed	1			
34	R9	39	86	46	red pine	two aged	shelterwood-seed	1			
42	R9	9	69	55	red pine	mature	shelterwood-seed	1			
comnts Fmd : Cutting period should be Sept. 1 - Mar. 1. Stay back from Lost Lake											
55	R9	5	78	60	red pine	mature	shelterwood-seed	3			
comnts Fmd : Stand was thinned in 2000. Delay treatment until remainder of stand is treated with Comp. 3.											
66	R9	25	81	65	red pine	mature	shelterwood-seed	1			
401	G0	5			grass	nonstocked		0	planting		
comnts Fmd : Opening to managed by Wildlife Division.											
402	G0	6			grass	nonstocked		0	planting		
comnts Fmd : Opening to be managed by Wildlife Division.											
<b>Total Acres.....</b>		<b>172</b>									

**Proposed Treatments  
With Limiting Factors**

**Compartment: 4**

**Entry Year: 2009**

---

<b>Stand</b>	<b>Cover Type</b>	<b>Acres</b>	<b>Age</b>	<b>Site Index</b>	<b>Mgt Obj</b>	<b>Condition</b>	<b>Method Cut</b>	<b>Harvest Priority</b>	<b>Cultural Need</b>	<b>FD Status</b>
--------------	-----------------------	--------------	------------	-----------------------	--------------------	------------------	-----------------------	-----------------------------	--------------------------	----------------------

---

TREATMENT LIMITING FACTORS:

---

**Total Acres..... 0**

# Field Map

Compartment 4  
 T34N, R01W, Sec. 22, 27, 34  
 County: Cheboygan  
 Unit: Pigeon River  
 YOE: 2009  
 Acres: 1,451 GIS Calculated  
 Stand Examiner: Rick McDonald  
 Map Revised: 6/11/2007  
 Map Phase: Pre-review

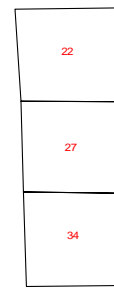

## Legend

- Miris Corners
- - - Gravel, County
- - - Poor Dirt, County
- - - Open Roads
- - - Closed,
- - - Trails
- Water Features
- Hiking Trails
- Horse Trails
- Stand Boundary
- 016 - Opening Maintenance
- 100 - Final Harvest
- 300 - Shelterwood - seed

