



**GWINN FOREST MANAGEMENT UNIT  
COMPARTMENT REVIEW PRESENTATION**

**COMPARTMENT # 260 ENTRY YEAR: 2007**

**Compartment GIS acres 808**

**County: 52 Marquette**

---

**Revision Date: 08/19/2005**

**Stand Examiner:** Warren J Heikkila

**Legal Description:** T45N, R27W, Sec. 13, and 14 .

**Management Goals:** For the 10 yr. period beginning in 2007, we will strive to perpetuate or increase the component of oak, birch, and dry, mesic conifers in a non-plantation setting, where they now occur.

**Soils and topography:** Ranging from relatively level creek bottoms, swamp conifer, tag alder, and bog/marshlands, to upland which is only rolling to moderately hilly (a few steep slopes in west end ). Generally good logging chance throughout, though access is somewhat lengthy.

**Ownership Patterns, Development, and Land Use in and Around the Compartment:** State ownership here is generally blocked in quite well to the north and east, but does border some relatively small private forest holdings on the southwest side of the compartment, mostly non-industrial private owners with recreational objectives. Also this compartment is bordered on the west by the Michigan Northwoods Club with holdings of approx 10,000 acres. In addition to being a hunting club, they actively manage their forest resource with professional advisement and management. Development is very limited with a few seasonal cottages or hunting camps widely distributed. Production of forest products along with low key recreational activities such as hunting, mushroom & berry picking, riding ORV's, hiking, and trapping make up the land uses here.

Unique, Natural Features (include only non-site specific and non-sensitive information): Hay Lake and it's outlet creek and other tributaries creeks and beaver ponds all emptying into the Middle Branch of the Escanaba River, make up the unique natural features on State land here.

Archeological, Historical, and Cultural Features (include only non-site specific and non-sensitive information):

**Special Management Designations or Considerations:** Potential Biodiversity Management areas consists of stands 3, 4, 7, 10, 16, 20, and 26.

**Watershed and Fisheries Considerations:**

**Wildlife Habitat Considerations:**

**Mineral Resource and Development Concerns and/or Restrictions:**  
**Compartment 260** Sections 13 and 14, T45N-R27W, Marquette County

Surface sediments consist of coarse-textured glacial till. The glacial drift thickness varies between 50 and 100 feet. The Precambrian Archean Granite/Gneiss subcrops below the glacial drift. This rock could be used as dimension stone. Gravel pits are not located in the area, but potential should be good. Abandoned iron mines are located ten miles to the north. There were previous metallic leases in this area. There is no economic oil and gas production in the UP.

**Vehicle Access:** The Hemmings Lake Road to the north and the Chain of Lakes Road (Co.Rd PX – gravel, leading east to M-35) to the southeast, are the two main access routes to reach this compartment. Various internal two track, narrow roads (some of which are bermed ), complete the access network for this compartment. Temporary roads are established for timber removal, but these are bermed, and often seeded for wildlife, or obliterated following timber sale completion.

**Survey Needs:** No survey needs are pressing for 2007.

**Recreational Facilities and Opportunities:** A designated (Bass Lake Trail), marked, and maintained Dept ORV trail passes through the southeast portion of this compartment. In addition to this, only low key recreational opportunities for activities such as hunting, trapping, hiking, mushroom & berry picking, etc. exist in this compartment.

**Fire Protection:** This compartment is included within the “581 Zone Dispatch” area which provides for a pre-planned dispatch of specified fire equipment from within the Gwinn and Crystal Falls Mgt. Units, dependent upon the severity of forecast burning conditions for a specific day. Areas of jack/red pine cover types with the encroachment of recreational seasonal and/or residential dwellings have warranted this pre-planning. Mutual aide agreements with local volunteer fire departments also provide critical fire suppression response, especially in the area of structural fire and/or protection, and evacuations.

#### **Additional Compartment Information:**

- **The following 5 reports from the Operations Inventory System (OIPC) are attached:**
  - ◆ **Cover Type by Age Class**
  - ◆ **Cover Type by Management Objective**
  - ◆ **Compartment Volume Summary**
  - ◆ **Proposed Treatments – No Limiting Factors**
  - ◆ **Proposed Treatments – With Limiting Factors**
  
- **The following information is displayed, where pertinent, on the attached compartment maps:**
  - ◆ **Base feature information, stand numbers, cover types**
  - ◆ **Proposed treatments**
  - ◆ **Proposed road access system**
  - ◆ **Suggested potential old growth**

09/19/2005 4:07:16 PM

Michigan Department of Natural Resources - Operations Inventory System  
Individual Compartment Report

ESCANABA RIVER STATE FOREST

GWINN FOREST MGT UNIT

MARQUETTE COUNTY

COMPARTMENT: 260

Table 3

(acres shown in boxes)

STAND AGE CLASS

COVER TYPE	Not Coded	0-9	10-19	20-29	30-39	40-49	50-59	60-69	70-79	80-89	90-99	100-109	110-119	120-129	130-139	140-149	150-159	All Aged	Total
Aspen		125	234						56	58	2								475
Bog or Marsh	19																		19
Grass	2		13																15
Jack Pine		8																	8
Mx Swmp Cnfr																		97	97
Oak									19										19
Paper Birch									68										68
Treed Bog	5																		5
Upland Hdwds																		21	21
Water	18																		18
White Pine																		63	63
<b>Total</b>	<b>44</b>	<b>133</b>	<b>247</b>						<b>143</b>	<b>58</b>	<b>2</b>							<b>181</b>	<b>808</b>

09/19/2005 4:07:23 PM

Michigan Department of Natural Resources - Operations Inventory System  
Individual Compartment Report

ESCANABA RIVER STATE FOREST

GWINN FOREST MGT UNIT

MARQUETTE COUNTY

COMPARTMENT: 260

Table 3A

(acres shown in boxes)

MANAGEMENT OBJECTIVE TYPE

COVER TYPE	A	S	V	C	G	H	J	I	L	P	N	Q	X	O	B	R	K	Y	F	E	T	D	U	M	Z	W	Total
A Aspen	475																										475
V Bog or Marsh			19																								19
G Grass					15																						15
J Jack Pine							8																				8
Q Mx Swmp Cnfr												97															97
O Oak														19													19
B Paper Birch															68												68
D Treed Bog																						5					5
M Upland Hdwds																								21			21
Z Water																									18		18
W White Pine																										63	63
<b>Total</b>	<b>475</b>		<b>19</b>		<b>15</b>		<b>8</b>					<b>97</b>		<b>19</b>	<b>68</b>							<b>5</b>		<b>21</b>	<b>18</b>	<b>63</b>	<b>808</b>

ESCANABA RIVER STATE FOREST

GWINN FOREST MGT UNIT

MARQUETTE COUNTY

COMPARTMENT: **260**

**Table 10 - COMPARTMENT VOLUME SUMMARY - ALL STANDS**

COMPARTMENT SUMMARY			
TOTAL VOLUME		CUT VOLUME	
Hardwood	6128 Cds	Hardwood	3816 Cds
Hardwood	113 Mbf	Softwood	504 Cds
Softwood	2881 Cds	Sum CutVol	4320 Cds
Softwood	465 Mbf		
Sum TotVol	10165 Cds		
<b>Total Cmpt Acres</b>		Acres Proposed For Cut.....	155
808			

**GWINN FOREST MGT UNIT**

**Proposed Treatments  
With NO Limiting Factors**

**Compartment: 260**    **Entry Year: 2007**

Stand	Cover Type	Acres	Age	Site Index	Mgt Obj	Condition	Method Cut	Harvest Priority	Cultural Need	FD Status
<b>2</b>	<b>A6</b>	56	72	55	aspen (upland)	mature	final harvest	1		
<p>comnts Fmd : ORV trail runs through stand. Aspen is the most abundant specie with about 26 sq.ft/acre, but this stand is a mix of many species: jack pine, birch, maple, black spruce along the northern edge near the swamp, and some red pine/white pine. Future stand will undoubtedly be dominated by aspen, fir (present understory), maple, and some jack pine.</p> <p>Wld : Located in SE1/4 &amp; SENE of Sec 13.</p>										
<b>9</b>	<b>B6</b>	39	75	60	paper birch	mature	seed tree	1		
<p>comnts Fmd : We will leave all oak, cherry, red &amp; white pine. East end of stand has more white pine regen on ground. We will separate out the northern hdwd remnant stand in the middle of this stand (it has sugar maple seedlings as a ground cover, plus rugged terrain). I believe most of this stand was northern hdwd type in pre-settlement times and subsequent cut followed by fire produced what we have today. Although mgt objective is birch, we would accept a mix of maple, aspen, &amp; upland conifer (pine &amp; spruce/fir) , or possibly plant oak/white pine as a component of future stand if birch doesn't succeed in restocking here.</p> <p>Wld : Located in the S1/2NW of Sec 13.</p>										
<b>23</b>	<b>A6</b>	58	80	70	aspen (upland)	mature	final harvest	1		
<p>comnts Fmd : East part of stand slopes down to the north. Less than 10 sq.ft/A of oak, but we will leave all oak. Old (pine days?) east west road present in stand. Could be used for skid trail. Note that the 1/4 corner between Sec 14/13 is located beneath the east-west private fence line.</p> <p>Wld : Located in the S1/2NE of Sec 14, and SWNW of Sec 13.</p>										
<b>27</b>	<b>A6</b>	2	95	72	aspen (upland)	mature	final harvest	1		
<p>comnts Fmd : Cut with adjacent stand to the north in Cmpt 258 in 2008. Cut the portion that is reasonably level and operable, stopping at steep slope dropping off to treed bog below. DNR pipe and cap at Section corner, plus single strand, rusty wire fence running north-south along Mich. Northwoods Club property.</p> <p>Wld : Located in the extreme northwest corner of NWNW Sec 14.</p>										
<b>Total Acres.....</b>		<b>155</b>								

**Proposed Treatments  
With Limiting Factors**

**Compartment: 260**    Entry Year: 2007

---

<b>Stand</b>	<b>Cover Type</b>	<b>Acres</b>	<b>Age</b>	<b>Site Index</b>	<b>Mgt Obj</b>	<b>Condition</b>	<b>Method Cut</b>	<b>Harvest Priority</b>	<b>Cultural Need</b>	<b>FD Status</b>
--------------	-----------------------	--------------	------------	-----------------------	--------------------	------------------	-----------------------	-----------------------------	--------------------------	----------------------

---

TREATMENT LIMITING FACTORS:

---

Total Acres..... 0

# Field Map

Compartment 260  
 T45N, R27W, Sec. 13, 14  
 County: Marquette  
 Unit: Gwinn  
 YOE: 2007  
 Acres: 808 Gis Calculated  
 Stand Examiner: Warren Heikkila  
 Map Revised: 9/20/2005  
 Map Phase: Pre-review

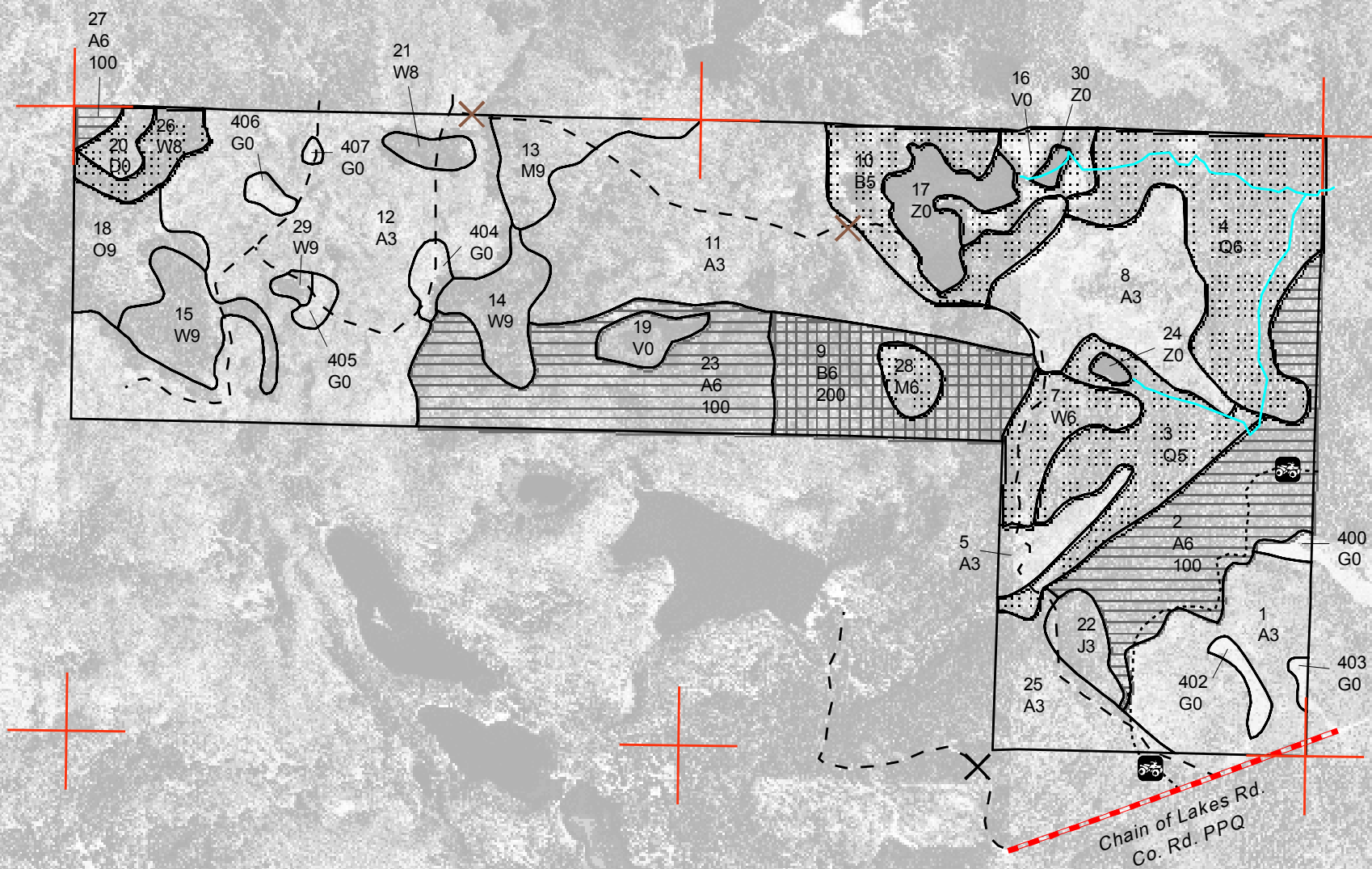
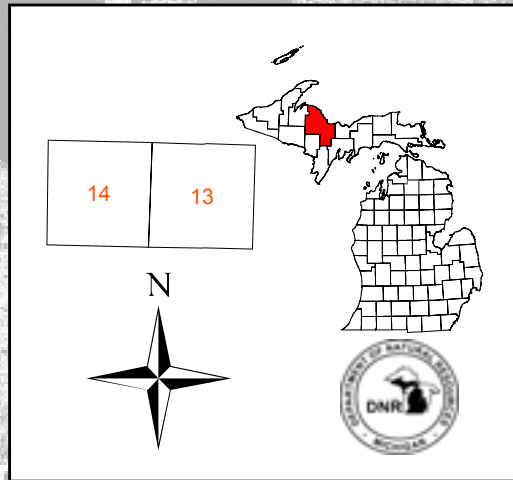

## Legend

- Miris Corners
- County Gravel Roads
- Poor Dirt roads
- Trails
- Hydrology
- ORV Trails
- Gates
- Natural Material
- Stand Boundary
- Biodiversity/Old Growth Area
- 100 - Final Harvest
- 200 - Seed Tree
- Name County Gravel Roads