



**FOREST MANAGEMENT UNIT  
COMPARTMENT REVIEW PRESENTATION**

**COMPARTMENT # 52 ENTRY YEAR: 2010**

**Compartment Acreage: 1283 County: Gladwin**

---

**Revision Dates:** Draft 8-26-08, Draft 10-30-08.

**Stand Examiner:** Mark Reichel

**Legal Description:** T 19N R 2E Sections 19, 20

**Management Goals:** This compartment is 71% lowland, including swamp hardwoods (25% of total) and Lowland brush (19%). 164 acres of aspen were reclassified as swamp aspen. Upland aspen comprises 23% of the compartment, and there is only 84 acres of it over the age of 19. Thus the only harvest this year of entry is a final harvest in 2 swamp jack pine stands totaling 22 acres. These stands will be replanted to jack pine. The swamp hardwood stands are too wet to operate equipment in. Finally, 41 acres of former bog have seeded in with jack pine and tamarack; they were reclassified as treed bog.

**Soil and Topography:** The compartment is flat and wet. The few high oak ridges are in the northeast  $\frac{1}{4}$  of section 20 and one in the far northeast corner of section 19. The eastern  $\frac{3}{4}$  of section 19 is in the poorly drained Hettinger-Brevort-Burleigh association soils. This area is mostly lowland brush with scattered poor quality aspen. Two drains run north-south through this area. The Black Creek drain has beaver activity and has flooded the aspen stands east and west of it in the south end of section 19. The Northeastern half of section 20 is very poorly drained Roscommon soils with mostly swamp hardwood stands that are too wet to cut. Most of the northern  $\frac{1}{2}$  of section 20 is in the poorly drained Au Gres-Kinross association, with either jack pine/tamarack bogs or lowland brush. The upland aspen stands in the southwestern  $\frac{1}{4}$  of section 20 are on somewhat poorly drained Iosco-Brevort-Ingalls soils with a few high knobs but depressions with swamp grass as well. The western  $\frac{1}{3}$  of section 19 is in two somewhat poorly drained soil associations: Allendale-Pinconning-Pickford (west central) and Iosco-Au Gres-Ingalls. This area has aspen and some swamp hardwood cover but the aspen stands have wet areas. Harvests in this area in 2003 regenerated moderately well, although portions of the stands reverted to lowland shrubs.

**Ownership Patterns, Development, and Land Use in and Around the Compartment:** This compartment is a continuous block bordering state land on the north and south. The entire western edge along Fournier Road has private ownership across the road, with 6 holdings and 5 residences, mostly permanent. Most of this land is forested but the northernmost property is a farm. There is one 40 acre private holding with a hunting cabin in the northwest corner of section 20 along Secord Dam road. There is also a private 160 on the northeast edge of section 20 which has a residence and a hunting blind adjacent to stand 47. The trail along the line may be lightly used by the adjacent property owner. The entire township to the east is mostly state forest, and Secord Township just to the west is heavily developed along Secord Lake.

**Unique, Natural Features:** MNFI database indicates a bald eagle nest near the west quarter corner of section 20; the nest was not spotted during inventory.

**Archeological, Historical, and Cultural Features:** None per HAL database, but a foundation was identified in the compartment. The Assistant State Archeologist was notified.

**Special Management Designations or Considerations:** None.

**Watershed and Fisheries Considerations:** There are two very small streams in stand 39 and 43, section 20 that are not a fisheries resource. Other than this there is only sheet flow and the two drains in section 19.

**Wildlife Habitat Considerations:**

**Mineral Resource and Development Concerns and/or Restrictions:** Surface sediments consist of lacustrine (lake) sand and gravel and fine-textured till. The glacial drift thickness varies between 100 and 200 feet. Beneath the glacial drift are the Pennsylvanian Grand River and Saginaw Formations. The Saginaw Formation is used for clay/shale in other areas of the State. This area is predominantly sand, and gravel potential in the compartment is considered limited. Very little oil and gas exploration has occurred in this area. There are no current State oil and gas leases in the compartment.

**Vehicle Access:** Secord Dam Road runs along the entire northern edge of the compartment, and Fornier Road along the entire western edge. There are no roads into the south and east end of the compartment. The ditches further block foot and vehicle travel from the west, so this area is fairly inaccessible. There is one good short road in section 20, along an oak ridge in the north central part of the section. Section 19 west of the ditch has no roads but can be accessed from Fornier road; there is a small parking area at the south end of the road. The rest of section 19 also has no driveable roads except for a short spur in the far northeast corner.

**Survey Needs:** None currently.

**Recreational Facilities and Opportunities:** The primary recreational use of the compartment is hunting. Section 19 west of the drain receives moderate use, and there are two hunting camps in the northeast corner. Section 20 seems to get moderate to light use.

**Fire Protection:**

11/3/2008 10:05:46 AM

Michigan Department of Natural Resources - Operations Inventory System  
Individual Compartment Report

AUSABLE STATE FOREST

GLADWIN FOREST MGT UNIT

GLADWIN COUNTY

COMPARTMENT: 52

Table 3

(acres shown in boxes)

STAND AGE CLASS

COVER TYPE	Not Coded	STAND AGE CLASS																All Aged	Total
		0-9	10-19	20-29	30-39	40-49	50-59	60-69	70-79	80-89	90-99	100-109	110-119	120-129	130-139	140-149	150-159		
Aspen		38	71	96		84													289
Black Spruce								6											6
Bog or Marsh	12																		12
Grass	11																		11
Jack Pine			18	5		5		17											45
LowInd Brush	211	11	16																238
LowInd Poplr		18	100	10		35		11											174
Marsh	84																		84
Oak		12		17				30											59
Swamp Hrdwds			23	19	27			17	220									15	321
Treed Bog	39																		39
Upland Hdwds				5															5
<b>Total</b>	<b>357</b>	<b>79</b>	<b>228</b>	<b>152</b>	<b>27</b>	<b>124</b>		<b>81</b>	<b>220</b>									<b>15</b>	<b>1283</b>

11/3/2008 10:05:55 AM

Michigan Department of Natural Resources - Operations Inventory System  
Individual Compartment Report

AUSABLE STATE FOREST

GLADWIN FOREST MGT UNIT

GLADWIN COUNTY

COMPARTMENT: 52

Table 3A

(acres shown in boxes)

MANAGEMENT OBJECTIVE TYPE

COVER TYPE	A	S	V	C	G	H	J	I	L	P	N	Q	X	O	B	R	K	Y	F	E	T	D	U	M	Z	W	Total
A Aspen	289																										289
S Black Spruce		6																									6
V Bog or Marsh			12																								12
G Grass					5										6												11
J Jack Pine							45																				45
L LowInd Brush									231											7							238
P LowInd Poplr										164										10							174
N Marsh											84																84
O Oak														50										9			59
E Swamp Hrdwds																				321							321
D Treed Bog																							39				39
M Upland Hdwds																								5			5
<b>Total</b>	289	6	12		5		45		231	164	84			50	6					338		39		14			1283

AUSABLE STATE FOREST

GLADWIN FOREST MGT UNIT

GLADWIN COUNTY

COMPARTMENT: **52**

**Table 10 - COMPARTMENT VOLUME SUMMARY - ALL STANDS**

COMPARTMENT SUMMARY			
TOTAL VOLUME		CUT VOLUME	
Hardwood	4486 Cds	Hardwood	10 Cds
Hardwood	945 Mbf	Softwood	280 Cds
Softwood	343 Cds	Softwood	7 Mbf
Softwood	7 Mbf	Sum CutVol	304 Cds
Sum TotVol	6733 Cds		
<b>Total Cmpnt Acres</b>		Acres Proposed For Cut.....	
1283		22	

**GLADWIN FOREST MGT UNIT**

**Proposed Treatments  
With NO Limiting Factors**

**Compartment: 52**

**Entry Year: 2010**

Stand	Cover Type	Acres	Age	Site Index	Mgt Obj	Condition	Method Cut	Harvest Priority	Cultural Need	FDF Status	
26	G0	6			red pine	nonstocked		0	planting		
comnts Fmd : Trench and plant red pine. Scattered aspen, oak, red map with bracken ground cov, grading into V at southeast end (still can be planted). Easy access along road.											
48	J6	17	58	48	jack pine	mature	final harvest	1	other - specify in remarks		
comnts Fmd : Final harvest. Use shortwood spec to leave tops for seed. Burn to regenerate. Use dry/frozen spec. Stand is J bog with vac/leatherleaf and sphagnum moss and some bracken at N end.											
148	J6	5	40	50	jack pine	immature	final harvest	1	other - specify in remarks		
comnts Fmd : Final harvest while cutting adjacent stand 48. Use shortwood only spec to leave tops in stand as seed source. Burn to regenerate. SI, YOO estimates. Ground cover about half vac.											
<b>Total Acres.....</b>		<b>28</b>									

**Proposed Treatments  
With Limiting Factors**

**Compartment: 52**

**Entry Year: 2010**

---

<b>Stand</b>	<b>Cover Type</b>	<b>Acres</b>	<b>Age</b>	<b>Site Index</b>	<b>Mgt Obj</b>	<b>Condition</b>	<b>Method Cut</b>	<b>Harvest Priority</b>	<b>Cultural Need</b>	<b>FD Status</b>
--------------	-----------------------	--------------	------------	-----------------------	--------------------	------------------	-----------------------	-----------------------------	--------------------------	----------------------

---

TREATMENT LIMITING FACTORS:

---

**Total Acres..... 0**

# Covertime & Treatment Map

Compartment 52  
 T19N, R2E, Sec. 19, 20  
 County: Gladwin  
 Unit: Gladwin  
 YOE: 2010  
 Acres: 1,283 GIS Calculated  
 Stand Examiner: Mark Reichel  
 Map Revised: 10/29/2008  
 Map Phase: Pre-Review

## Legend

- |                                  |   |
|----------------------------------|---|
| — Miris Corners                  | <b>Cover Types</b>                                  |
| — Paved Roads                    | ■ A - Aspen   |
| == Gravel Roads                  | ■ D - Treed Bog                                     |
| - - County Gravel Roads          | ■ E - Swamp Hardwoods                               |
| - - Poor Dirt Roads              | ■ G - Grass   |
| ... Trails                       | ■ J - Jack Pine                                     |
| — Water Features                 | ■ L - Lowland Brush                                 |
| □ Stand Boundaries               | ■ M - Northern Hardwoods                            |
| ▨ 016 - Planting                 | ■ N - Marsh   |
| ▨ 316 - Shelterwood-see/Planting | ■ O - Oak   |
|                                  | ■ P - Balsam Poplar, Swamp Aspen, Swamp White Birch |
|                                  | ■ S - Black Spruce Swamp                            |
|                                  | ■ V - Bog or Muskeg                                 |

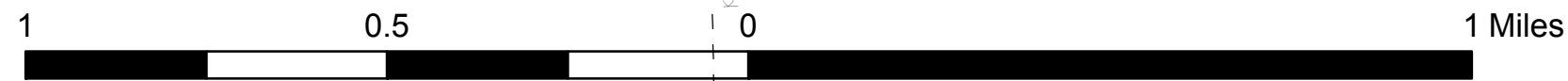
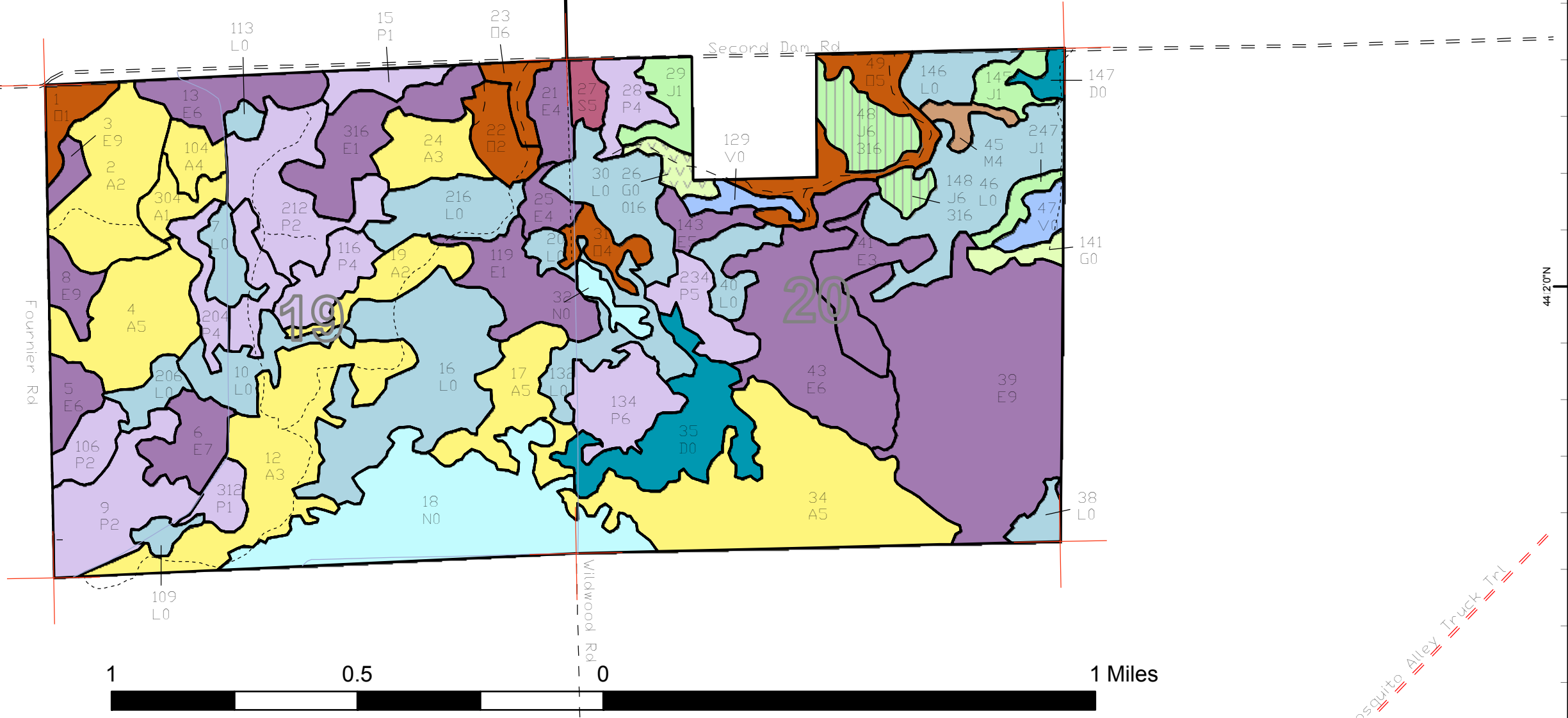
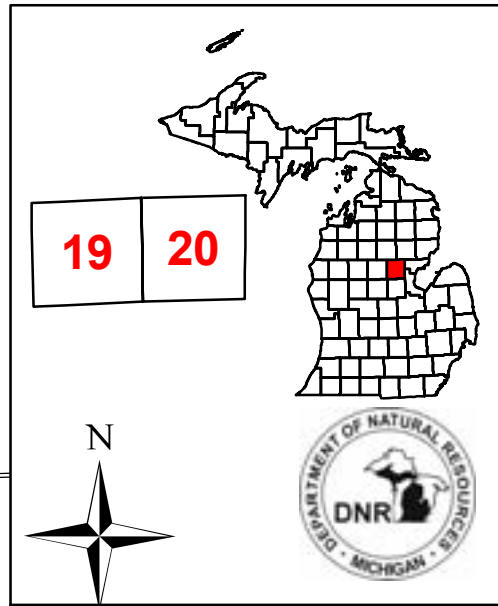

84:18:0"W 84:17:0"W 84:16:0"W 84:15:0"W 84:14:0"W

44:30"N

44:20"N

44:30"N





44:20"N



Compartment 52  
 T19N, R2E, Sec. 19, 20  
 County: Gladwin  
 Unit: Gladwin  
 YOE: 2010  
 Acres: 1,283 GIS Calculated  
 Stand Examiner: Mark Reichel  
 Map Revised: 10/29/2008  
 Map Phase: Pre-Review



# Dedicated & Proposed Special Conservation Area Map

**Legend**

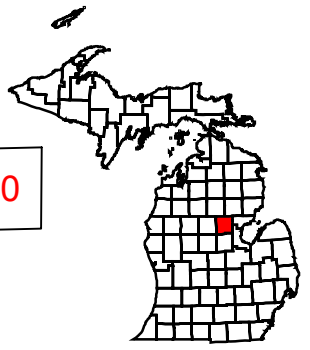
-  Miris Corners
-  Stand Boundaries
-  Proposed Special Conservation Areas
-  SCA - Special Conservation Areas

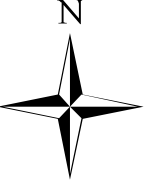

19 20

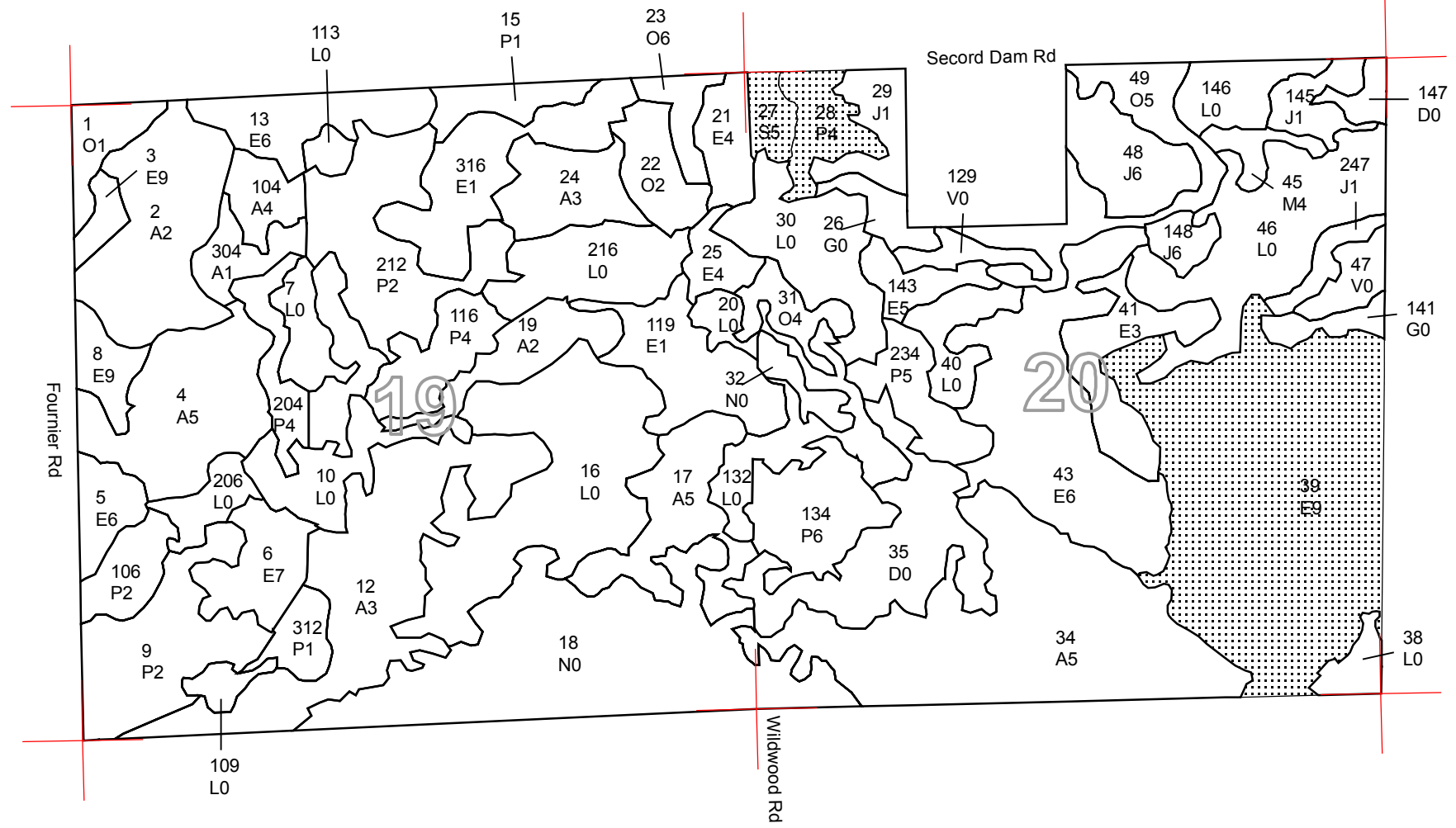
84°18'0"W 84°17'0"W 84°16'0"W 84°15'0"W 84°14'0"W

44°30'N

44°20'N

44°30'N

44°20'N

44°10'N



### DEDICATED CONSERVATION AREA DETAILS

\* This is a list of Dedicated Biodiversity Areas for this compartment along with a 1/4 mile buffer surrounding the compartment. Refer to Dedicated Conservation Area Map for areas that the below listed Conservation Areas are located.

ERA = Ecological Reference Area  
HCVA = High Conservation Value Area  
SCA = Special Conservation Area

<b>Conservation Area</b>	<b>Type</b>	<b>Description</b>
--------------------------	-------------	--------------------

---

---