



**BARAGA FOREST MANAGEMENT UNIT
COMPARTMENT REVIEW PRESENTATION**

COMPARTMENT # 81 ENTRY YEAR: 2006

Compartment Acreage: 3,588 County: Keweenaw

Revision Date: October 3, 2005

Stand Examiner:

Turunen, Nelson, Ferris

Legal Description:

T58N R27W, Section 5, 6, 7, 8, 9, 16, 17

RMU (if applicable):

N/A

Management Goals:

Manage for recreation and resource protection.

Soil and Topography:

The upland is hilly to rolling; soils are Arcadian-Dishno-Rock Outcrop complex, Arcadian-Michigamme-Rock Outcrop complex, Trimountain-Lac La Belle-Michigamme complex, Gratiot-Sabattis complex, Montreal-Paavola-Dishno complex, Wallace-Rubicon sands on the upland, and Lupton and Tawas mucks, Tawas-Deford mucks in the lowlands.

Ownership Patterns, Development, and Land Use in and Around the Compartment:

Lands to the west are forest industry; there are small private ownerships to the east, and state land to the south. The Nature Conservancy owns property to the north and east.

Unique, Natural Features (include only non-site specific and non-sensitive information):

There are threatened and endangered plants in the area.

Archeological, Historical, and Cultural Features (include only non-site specific and non-sensitive information):

No features have been identified.

Special Management Designations or Considerations:

This has not been designated as a special management area; however, it will be treated as a highly sensitive area.

Watershed and Fisheries Considerations:

Stream crossings on Union Creek should be upgraded.

Wildlife Habitat Considerations:

Feature oak where present; mark trees growing under and around oaks so as to release oak crowns and to stimulate oak reproduction. This compartment features threatened and endangered plant species.

Mineral Resource and Development Concerns and/or Restrictions:

Surface sediments consist of coarse-textured glacial till and lacustrine (lake) sand and gravel thin to discontinuous along the coastline. There is insufficient data to determine the glacial drift thickness. The Precambrian Copper Harbor Conglomerate and Portage Lake Conglomerate subcrop below the glacial drift. The Copper Harbor Conglomerate was previously mined for small amounts of copper. There are no gravel pits in the area, but there may be some potential. Abandoned copper mines are located to the west. The Compartment has not been leased for metallic exploration. There is no economic oil and gas production in the UP.

Vehicle Access:

Access is via the Mandan Road off of the end of US-41. Access is poor (the roads are rough). Stream crossings need to be upgraded. Roads should be upgraded, but not to high speed gravel roads.

Survey Needs:

Internal survey corners are needed to identify private land. This is not a high priority at this time.

Recreational Facilities and Opportunities:

There are no developed recreational facilities. The advisory committee recommended several small campsites, hiking trails and a parking area at High Rock Bay.

Fire Protection:

This is not a fire prone area

Additional Compartment Information:

A citizens committee made recommendations for management for this compartment and compartments 75 and 82. These recommendations and the recommendations from the Baraga Management Unit are being reviewed by the Lansing office.

- **The following 5 reports from the Operations Inventory System (OIPC) are attached:**
 - ◆ **Cover Type by Age Class**
 - ◆ **Cover Type by Management Objective**
 - ◆ **Compartment Volume Summary**
 - ◆ **Proposed Treatments – No Limiting Factors**
 - ◆ **Proposed Treatments – With Limiting Factors**

- **The following information is displayed, where pertinent, on the attached compartment maps:**
 - ◆ **Base feature information, stand numbers, cover types**
 - ◆ **Proposed treatments**
 - ◆ **Proposed road access system**
 - ◆ **Suggested potential old growth**

10/10/2005 8:59:00 AM

Michigan Department of Natural Resources - Operations Inventory System
Individual Compartment Report

COPPER COUNTRY STATE FOREST

BARAGA FOREST MGT UNIT

KEWEENAW COUNTY

COMPARTMENT: 81

Table 3

(acres shown in boxes)

STAND AGE CLASS

COVER TYPE	Not Coded	0-9	10-19	20-29	30-39	40-49	50-59	60-69	70-79	80-89	90-99	100-109	110-119	120-129	130-139	140-149	150-159	All Aged	Total
Aspen		99						63		205									367
Bog or Marsh	82																		82
Cedar								151			60							31	242
Lowlnd Brush	76																		76
Marsh	4																		4
Mx Swmp Cnfr																		11	11
Paper Birch						154													154
Spruce Fir							106			102									208
Treed Bog	50																		50
Upland Hdwds																		2092	2092
Water	295																		295
White Pine																	7		7
Total	507	99				154	106	214		307	60						7	2134	3588

10/10/2005 8:59:07 AM

Michigan Department of Natural Resources - Operations Inventory System
Individual Compartment Report

COPPER COUNTRY STATE FOREST

BARAGA FOREST MGT UNIT

KEWEENAW COUNTY

COMPARTMENT: 81

Table 3A

(acres shown in boxes)

MANAGEMENT OBJECTIVE TYPE

COVER TYPE	A	S	V	C	G	H	J	I	L	P	N	Q	X	O	B	R	K	Y	F	E	T	D	U	M	Z	W	Total
A Aspen	367																										367
V Bog or Marsh			82																								82
C Cedar				211															31								242
L Lowlnd Brush									76																		76
N Marsh											4																4
Q Mx Swmp Cnfr												11															11
B Paper Birch															154												154
F Spruce Fir																			208								208
D Treed Bog																							50				50
M Upland Hdwds																								2092			2092
Z Water																									295		295
W White Pine																										7	7
Total	367		82	211					76		4	11			154				239			50		2092	295	7	3588

COPPER COUNTRY STATE FOREST

BARAGA FOREST MGT UNIT

KEWEENAW COUNTY

COMPARTMENT: 81

Table 10 - COMPARTMENT VOLUME SUMMARY - ALL STANDS

COMPARTMENT SUMMARY			
TOTAL VOLUME		CUT VOLUME	
Hardwood	22621 Cds	Hardwood	244 Cds
Hardwood	3553 Mbf	Hardwood	32 Mbf
Softwood	12120 Cds	Sum CutVol	308 Cds
Softwood	605 Mbf		
Sum TotVol	43057 Cds		
Total Cmpt Acres		Acres Proposed For Cut.....	
3588		0	

**Proposed Treatments
With NO Limiting Factors**

Compartment: 81

Entry Year: 2006

Stand	Cover Type	Acres	Age	Site Index	Mgt Obj	Condition	Method Cut	Harvest Priority	Cultural Need	FDF Status
--------------	-----------------------	--------------	------------	-----------------------	--------------------	------------------	-----------------------	-----------------------------	--------------------------	-----------------------

Total Acres..... 0

**Proposed Treatments
With Limiting Factors**

Compartment: 81

Entry Year: 2006

Stand	Cover Type	Acres	Age	Site Index	Mgt Obj	Condition	Method Cut	Harvest Priority	Cultural Need	FD Status
--------------	-----------------------	--------------	------------	-----------------------	--------------------	------------------	-----------------------	-----------------------------	--------------------------	----------------------

TREATMENT LIMITING FACTORS:

Total Acres..... 0

Field Map

Compartment 82
 T58N, R28W, Sec. 11, 14, 21-28
 T57N, R28W, Sec. 35, 36
 County: Keweenaw
 Unit: Baraga
 YOY: 2007
 Acres: 2,354 GIS Calculated
 Stand Examiner: Martin Nelson
 Map Revised: 10/06/2005
 Map Phase: Pre-review

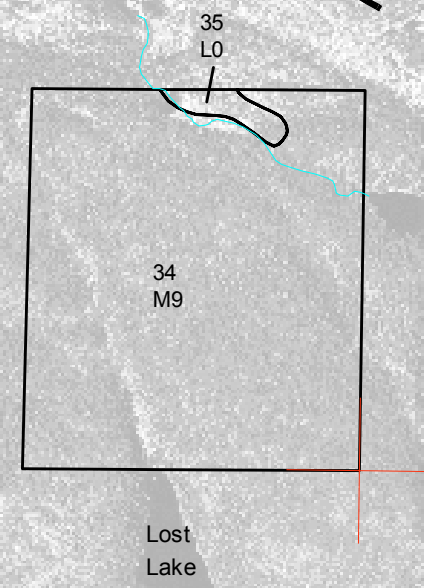
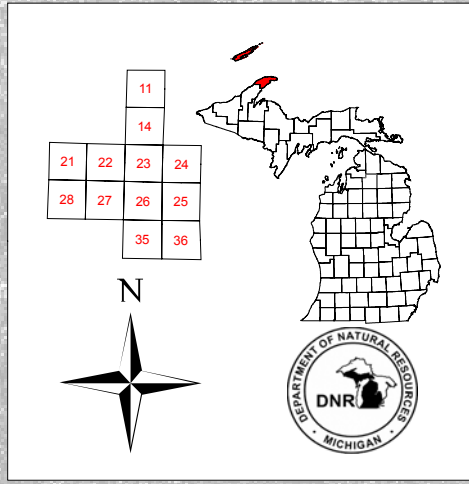

- Legend**
- Miris Corners
 - Gravel Roads
 - Poor Dirt Roads
 - Closed Roads
 - Trails
 - Water Features
 - Stand Boundary
 - ▨ Biodiversity/Old Growth area
 - ▩ 848 - Selection/Natural regeneration/Other
 - Name Gravel Roads
 - Name Water Features

