



**ATLANTA FOREST MANAGEMENT UNIT
COMPARTMENT REVIEW PRESENTATION**

COMPARTMENT # 141 ENTRY YEAR: 2009

Compartment Acreage: 1,967 County: Presque Isle

Revision Date: October 16, 2007

Stand Examiner: Tim Paulus

Legal Description: T33N R07E Sec 4
T34N R07E Sec. 21,28, 33

RMU (if applicable):

Management Goals:

The main goal in this compartment is to conduct multiple resource management for the good of the citizens of the State of Michigan.

Soil and Topography: The topography of the compartment varies from emergent limestone ridges to low, wet drainages. Soils are very shallow and rocky. Emergent limestone dominates most of the upland.

Ownership Patterns, Development, and Land Use in and Around the Compartment:

The compartment has mostly state land surrounding it as its topography and soils don't support many activities other than hunting.

Unique, Natural Features:

Some species are present in and around the compartment. The compartment also has many areas of Alvar.

Archeological, Historical, and Cultural Features.

None known.

Special Management Designations or Considerations:

None

Watershed and Fisheries Considerations:

Fisheries Concerns is General:

Wildlife Habitat Considerations:

Mineral Resource and Development Concerns and/or Restrictions:

Vehicle Access:

This compartment is accessed from Miller road to the west, US-23 to the north, and N. Grand lake Hwy. to the east. Access is very rough and difficult at best. A very remote compartment.

Survey Needs:

None.

Recreational Facilities and Opportunities:

Hunting and wildlife viewing.

Fire Protection:

Fire response to the compartment will be covered by the Onaway and Alpena DNR office as well as the Presque Isle #2 Fire Department.

Additional Compartment Information:

- **The following 5 reports from the Operations Inventory System (OIPC) are attached:**
 - ◆ **Cover Type by Age Class**
 - ◆ **Cover Type by Management Objective**
 - ◆ **Compartment Volume Summary**
 - ◆ **Proposed Treatments – No Limiting Factors**
 - ◆ **Proposed Treatments – With Limiting Factors**

- **The following information is displayed, where pertinent, on the attached compartment maps:**
 - ◆ **Base feature information, stand numbers, cover types**
 - ◆ **Proposed treatments**
 - ◆ **Proposed road access system**
 - ◆ **Suggested potential old growth**

8/21/2007 10:43:26 AM

Michigan Department of Natural Resources - Operations Inventory System
Individual Compartment Report

MACKINAW STATE FOREST

ATLANTA FOREST MGT UNIT

PRESQUE ISLE COUNTY

COMPARTMENT: 141

Table 3A

(acres shown in boxes)

MANAGEMENT OBJECTIVE TYPE

COVER TYPE	A	S	V	C	G	H	J	I	L	P	N	Q	X	O	B	R	K	Y	F	E	T	D	U	M	Z	W	Total	
A Aspen	60																										60	
S Black Spruce		119																										119
C Cedar				54																								54
G Grass					12																							12
L Lowlnd Brush									93																			93
P Lowlnd Poplr										988																		988
N Marsh											38																	38
Q Mx Swmp Cnfr												302																302
X Non Stocked													7															7
R Red Pine															42													42
F Spruce Fir																			59									59
T Tamarack																					46							46
U Upland Brush																								94				94
Z Water																									13			13
W White Pine																										40		40
Total	60	119		54	12				93	988	38	302	7		42			59		46			94		13	40	1967	

MACKINAW STATE FOREST

ATLANTA FOREST MGT UNIT

PRESQUE ISLE COUNTY

COMPARTMENT: **141**

Table 10 - COMPARTMENT VOLUME SUMMARY - ALL STANDS

COMPARTMENT SUMMARY			
TOTAL VOLUME		CUT VOLUME	
Hardwood	6192 Cds	Hardwood	4 Cds
Hardwood	306 Mbf	Softwood	10 Cds
Softwood	8007 Cds	Softwood	1 Mbf
Softwood	236 Mbf	Sum CutVol	16 Cds
Sum TotVol	15283 Cds		
Total Cmpnt Acres		Acres Proposed For Cut..... 0	
1967			

Proposed Treatments With NO Limiting Factors **Compartment: 141** **Entry Year: 2009**

Stand	Cover Type	Acres	Age	Site Index	Mgt Obj	Condition	Method Cut	Harvest Priority	Cultural Need	FDI Status
-------	------------	-------	-----	------------	---------	-----------	------------	------------------	---------------	------------

Total Acres..... 0

**Proposed Treatments
With Limiting Factors**

Compartment: 141

Entry Year: 2009

Stand	Cover Type	Acres	Age	Site Index	Mgt Obj	Condition	Method Cut	Harvest Priority	Cultural Need	FD Status
--------------	-----------------------	--------------	------------	-----------------------	--------------------	------------------	-----------------------	-----------------------------	--------------------------	----------------------

TREATMENT LIMITING FACTORS:

Total Acres..... 0

Field Map

Traillhead Rd

Old State Rd

CO Rd 638

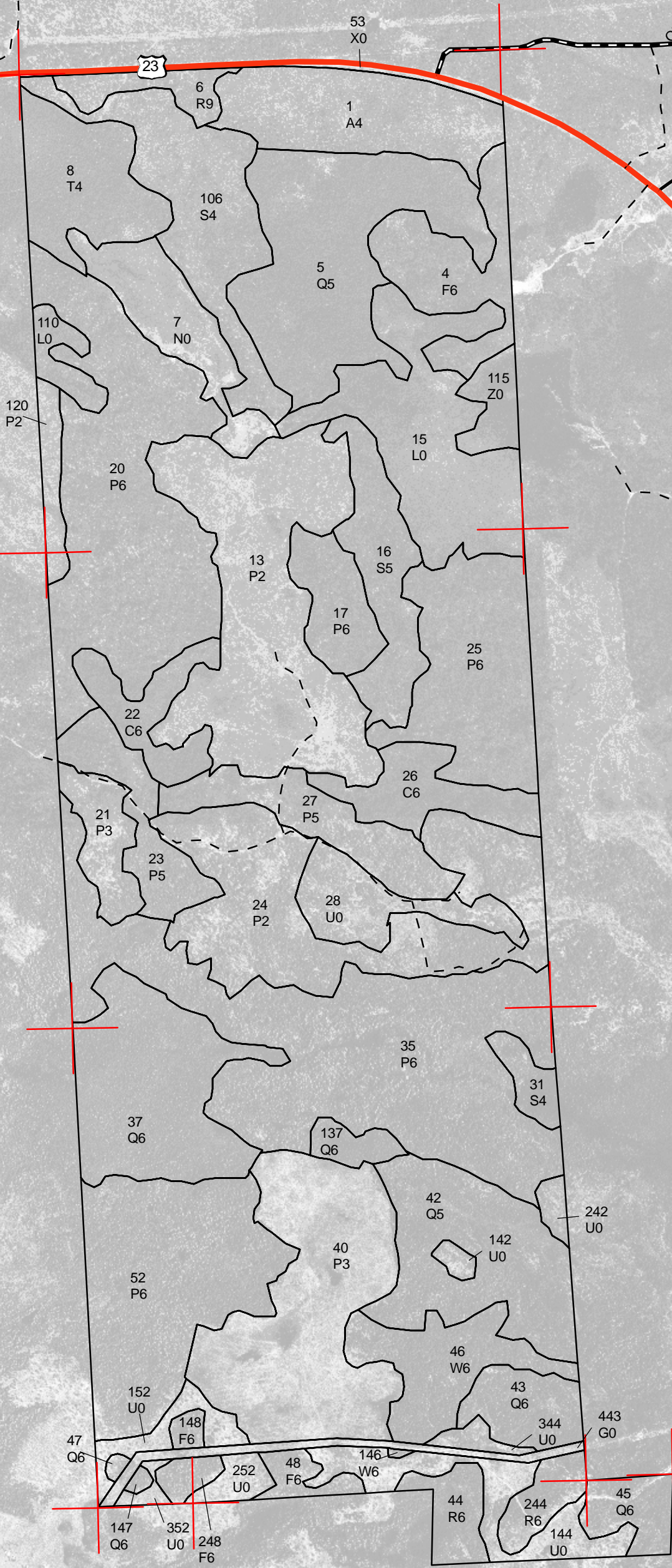

Compartment 141
 T33N, R07E, Sec. 4
 T34N, R07E, Sec. 21, 28, 33
 County: Presque Isle
 Unit: Atlanta
 YOE: 2009
 Acres: 1,967 GIS Calculated
 Stand Examiner: Timothy Paulus
 Map Revised: 8/06/2007
 Map Phase: Pre-review

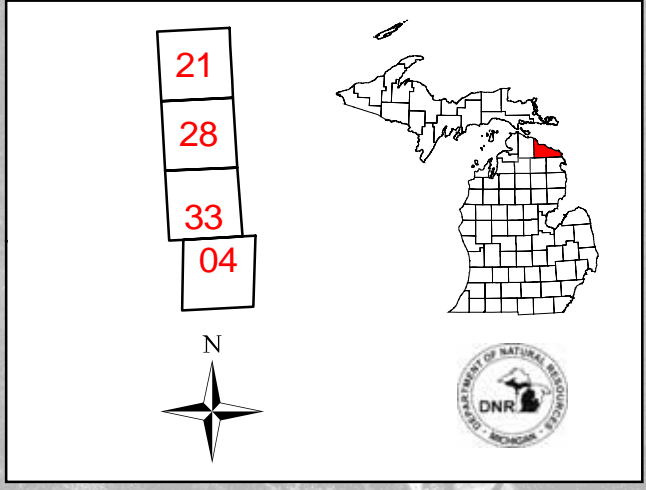

- Legend**
- Miris Corners
 - Highway
 - Paved
 - Gravel
 - Poor Dirt
 - Stand Boundary

