



**ATLANTA FOREST MANAGEMENT UNIT
COMPARTMENT REVIEW PRESENTATION**

COMPARTMENT #139 ENTRY YEAR: 2007

Compartment Acreage: 508

County: Presque Isle

Revision Date: August 22, 2005

Stand Examiner: Tim Paulus

Legal Description: T34N, R6E, Sec.23, 24, 26 & 36 .

RMU (if applicable):

Management Goals:Timber and Wildlife

Soil and Topography: Very shallow,rocky soils; topography is mostly flat with a few low ridges.

Ownership Patterns, Development, and Land Use in and Around the Compartment: Mostly private recreational holding in this area.

Unique, Natural Features (include only non-site specific and non-sensitive information): Limestone shelf rock emerges at the surface through out the compartment.

Archeological, Historical, and Cultural Features:

None known.

Special Management Designations or Considerations: None

Watershed and Fisheries Considerations: Do not disturb shallow wet soils.
Fisheries Concerns are General.

Wildlife Habitat Objectives and Considerations: This compartment is located in Presque Isle county approximately eight miles southeast of Rogers City along US-23 and four miles due west of Grand Lake. It

is part of an 18 square mile landscape that is a mix of both private and State Forest Lands. The topography is mostly flat lowlands.

The compartment is located in Ecoregion VII.6.3 of limestone bedrock with thin, well-drained sandy loam soils in the north unit and flat lake plain with very poorly drained muck/peat soils in the southern units. Kotar's cover typing system classifies this landscape as a northern hardwood management unit in the north and wetlands in the southern units. Cover types include PArVHa, AFO and mixed wetlands in the north and wetlands in the south. Fire history was minimal on this terrain. GLO data suggests this land was forested with red/white pine on the northern upland sites with some northern hardwoods on the edges and cedar on the southern units. A deer habitat model indicates that this landscape provides high thermal cover ratings (.80), fall/winter food potential at .50 to .60 and low (.17) spring/summer habitat in the south units and very high (1.0) in the north unit. Today this compartment supports a mix of habitat types of which 95% is aspen (37%), swamp conifers (28% (cedar 13%)), northern hardwoods (19%) and spruce fir (11%).

Today's cover types provide a high (400+ acres) habitat potential for black-capped chickadee, brown snake, red fox, bear, bobcat, northern short-tailed shrew, coyote and long-tailed weasel to name a few species. The planned treatments are not expected to affect the species listed above.

Mineral Resource and Development Concerns and/or Restrictions: Surface sediments consist of lacustrine (lake) sand and gravel. The glacial drift thickness varies between 0 and 10 feet. Beneath the glacial drift is the Devonian Traverse Group. The Traverse is quarried for limestone and cement products near Alpena. A gravel pit is located in Section 23, and potential is located in Sections 23 and 24. This area is located in the Niagaran reef trend and north of the Antrim Shale play. None of the State land is leased for oil and gas development and potential appear to be limited.

Vehicle Access: Limited by water table and rocky soils

Survey Needs: None

Recreational Facilities and Opportunities: None

Fire Protection: Posen VFD and MDNR

Additional Compartment Information:

- **The following 5 reports from the Operations Inventory System (OIPC) are attached:**
 - ◆ **Cover Type by Age Class**
 - ◆ **Cover Type by Management Objective**
 - ◆ **Compartment Volume Summary**
 - ◆ **Proposed Treatments – No Limiting Factors**
 - ◆ **Proposed Treatments – With Limiting Factors**

- **The following information is displayed, where pertinent, on the attached compartment maps:**
 - ◆ **Base feature information, stand numbers, cover types**
 - ◆ **Proposed treatments**
 - ◆ **Proposed road access system**
 - ◆ **Suggested potential old growth**

09/01/2005 11:05:52 AM

Michigan Department of Natural Resources - Operations Inventory System
Individual Compartment Report

MACKINAW STATE FOREST

ATLANTA FOREST MGT UNIT

PRESQUE ISLE COUNTY

COMPARTMENT: 139

Table 3

(acres shown in boxes)

STAND AGE CLASS

COVER TYPE	Not Coded	0-9	10-19	20-29	30-39	40-49	50-59	60-69	70-79	80-89	90-99	100-109	110-119	120-129	130-139	140-149	150-159	All Aged	Total
Aspen			56			18		54	57										185
Black Spruce							8		22	3									33
Cedar											66								66
Grass	1																		1
Lowlnd Brush	15																		15
Mx Swmp Cnfr								15			7								22
Non Stocked	5																		5
Spruce Fir					6			42	8										56
Swamp Hrdwds										8									8
Tamarack			20																20
Upland Hdwds							26				7							64	97
Total	21		76		6	18	34	111	87	11	80							64	508

09/01/2005 11:05:59 AM

Michigan Department of Natural Resources - Operations Inventory System
Individual Compartment Report

MACKINAW STATE FOREST

ATLANTA FOREST MGT UNIT

PRESQUE ISLE COUNTY

COMPARTMENT: 139

Table 3A

(acres shown in boxes)

MANAGEMENT OBJECTIVE TYPE

COVER TYPE	A	S	V	C	G	H	J	I	L	P	N	Q	X	O	B	R	K	Y	F	E	T	D	U	M	Z	W	Total
A Aspen	185																										185
S Black Spruce		33																									33
C Cedar				66																							66
G Grass																							1				1
L Lowlnd Brush									15																		15
Q Mx Swmp Cnfr												22															22
X Non Stocked													3										2				5
F Spruce Fir																			56								56
E Swamp Hrdwds																				8							8
T Tamarack																					20						20
M Upland Hdwds																								97			97
Total	185	33		66					15			22	3						56	8	20		3	97			508

MACKINAW STATE FOREST

ATLANTA FOREST MGT UNIT

PRESQUE ISLE COUNTY

COMPARTMENT: 139

Table 10 - COMPARTMENT VOLUME SUMMARY - ALL STANDS

COMPARTMENT SUMMARY			
TOTAL VOLUME		CUT VOLUME	
Hardwood	2921 Cds	Hardwood	452 Cds
Hardwood	18 Mbf	Sum CutVol	452 Cds
Softwood	1637 Cds		
Sum TotVol	4594 Cds		
Total Cmpt Acres		Acres Proposed For Cut.....	44
508			

ATLANTA FOREST MGT UNIT

**Proposed Treatments
With NO Limiting Factors**

Compartment: 139 **Entry Year: 2007**

Stand	Cover Type	Acres	Age	Site Index	Mgt Obj	Condition	Method Cut	Harvest Priority	Cultural Need	FDF Status	
14	X0	2		48	upland brush	nonstocked		0	other - specify in remarks		
comnts Fmd : OLD BORROW PIT, VERY ROCKY, SOME CONIFER SEEDLINGS											
Wld : allow this old gravel pit to convert to upland brush.											
26	M6	10	55	72	northern hardwood	mature		0	cleaning & weeding		
comnts Fmd : YOUNG HARDWOOD STAND.											
Wld : leave some tree length with tops on ground after stand is treated.											
126	M6	8	55	72	northern hardwood	mature		0	cleaning & weeding		
comnts Fmd : YOUNG HARDWOOD STAND.											
Wld : see comments for stand 26											
420	G0	1		55	upland brush	nonstocked		0	other - specify in remarks		
comnts Fmd : NO LEGAL ACCESS.											
Wld : allow stand to convert to upland brush											
Total Acres.....		21									

ATLANTA FOREST MGT UNIT

**Proposed Treatments
With Limiting Factors**

Compartment: 139 Entry Year: 2007

Stand	Cover Type	Acres	Age	Site Index	Mgt Obj	Condition	Method Cut	Harvest Priority	Cultural Need	FDF Status
2	M6	64		54	northern hardwood	nonstocked		0	cleaning & weeding	

TREATMENT LIMITING FACTORS: Adjacent landowner denies access

comnts Fmd : FIREWOOD SALE-NOT FDF QUALITY-SMALL D.A. - LOW PRIORITY WEEDING. NO LEGAL ACCESS

Wld : leave some tree length with tops on ground after treatment.

20	A6	2	74	55	aspen (upland)	mature	final harvest	1		
-----------	-----------	---	----	----	----------------	--------	---------------	---	--	--

TREATMENT LIMITING FACTORS: Adjacent landowner denies access

comnts Fmd : MARK HDWD, OAK, & PINE TO LEAVE. CLEARCUT THE REST. NO LEGAL ACCESS.

Wld : use drumming log spec if stand is ever treated.

27	A5	35	75	52	aspen (upland)	mature	final harvest	2		
-----------	-----------	----	----	----	----------------	--------	---------------	---	--	--

TREATMENT LIMITING FACTORS: Water quality/bmps

comnts Fmd : STAY OUT OF WET AREAS. LEAVE OAK

Wld : see stand 20 comments.

120	A6	7	74	55	aspen (upland)	mature	final harvest	1		
------------	-----------	---	----	----	----------------	--------	---------------	---	--	--

TREATMENT LIMITING FACTORS: Adjacent landowner denies access

comnts Fmd : MARK HDWD, OAK, & PINE TO LEAVE. CLEARCUT THE REST. NO LEGAL ACCESS.

Wld : see stand 20 comments.

Total Acres..... 108

Field Map

Compartment 139
 T34N, R6E, Sec. 23, 24, 26, 36
 County: Presque Isle
 Unit: Atlanta
 YOY: 2007
 Acres: 508 GIS Calculated
 Stand Examiner: Timothy Paulus
 Map Revised: 8/31/2005
 Map Phase: Pre-review

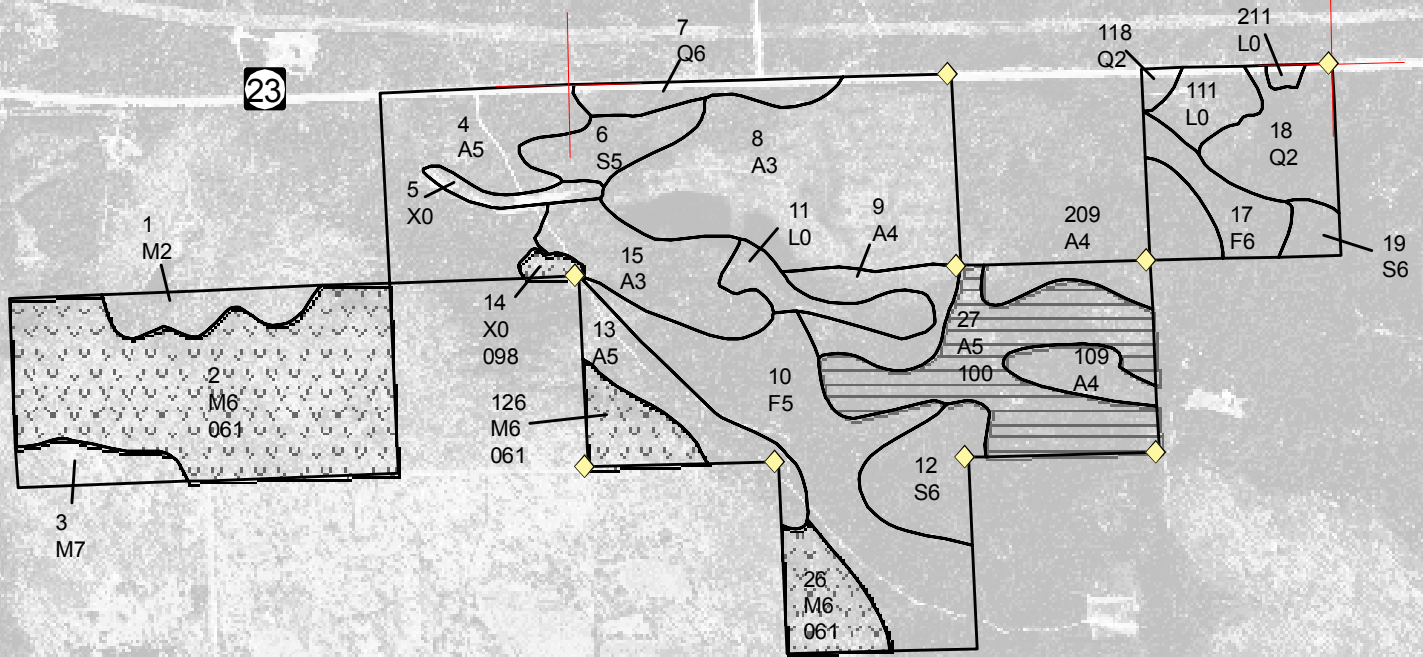
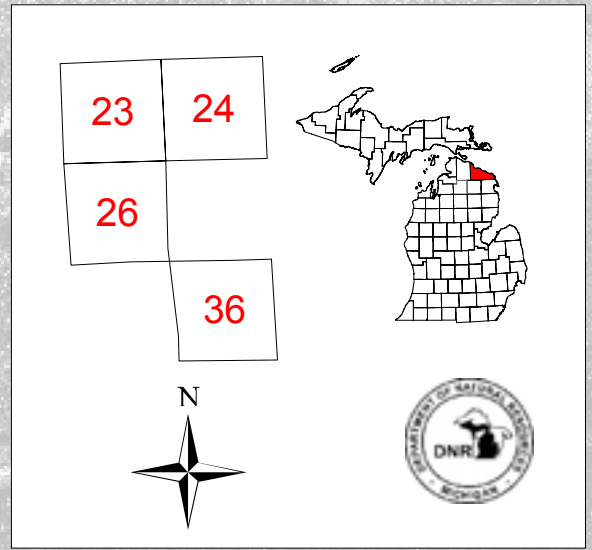

Legend

- ◆ RLS Corners
- Miris Corners
- - - Poor Dirt Roads
- State Highway
- ▭ Stand Boundary
- ▨ Biodiversity/Old Growth Area
- ▧ 061 - Cleaning-weeding/Hand Tools
- ▩ 098 - Other
- 100 - Final Harvest
- Name Poor Dirt Roads
- Name Water Features

